

REPLACEMENT PARTS MANUAL

COIL AND ROLLER CHAIN
HOOK AND LUG SUSPENSIONS
PUSH BUTTON OR PULL CORD CONTROL
CAPACITIES: 1/8 THRU 3 TONS

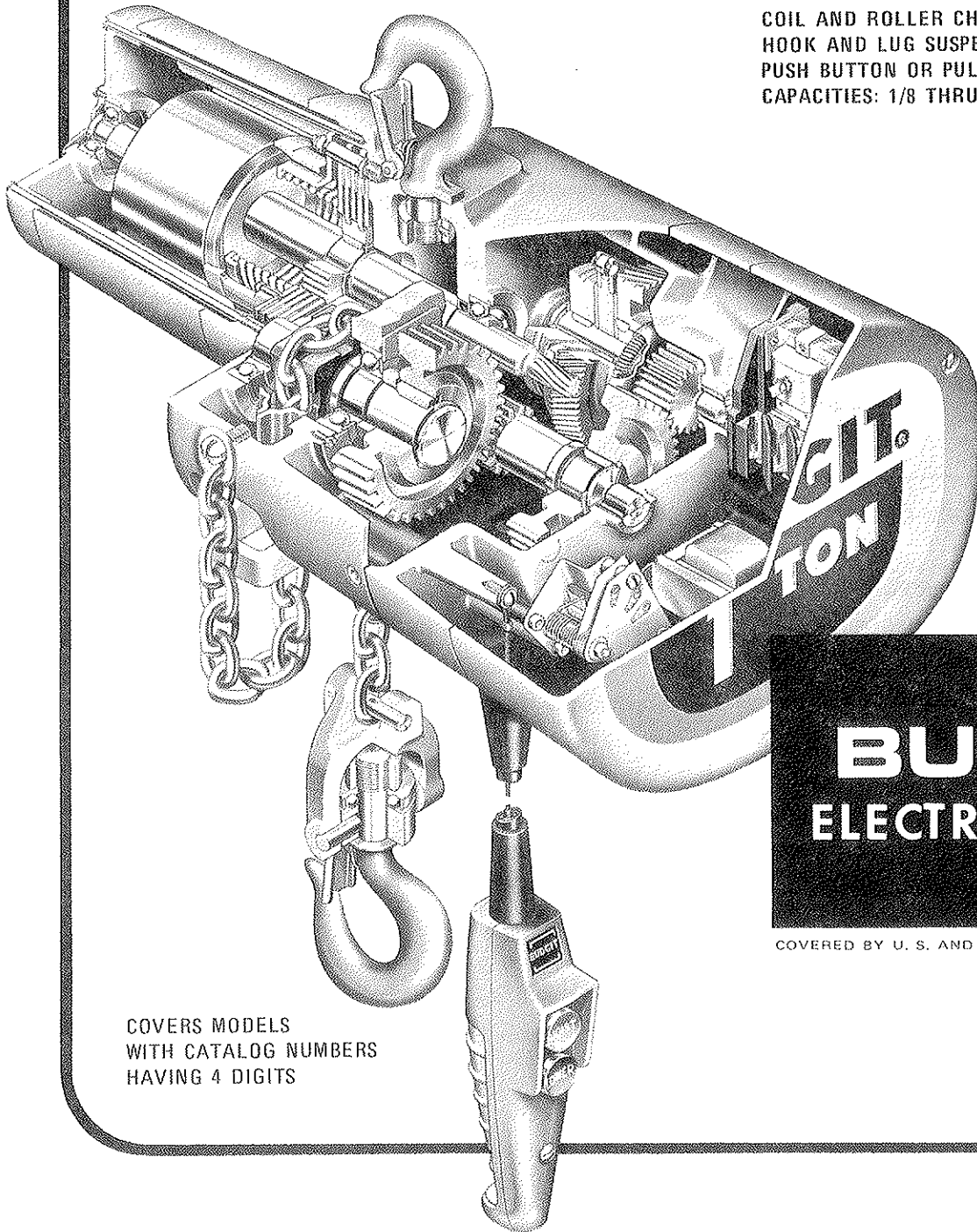

BUDGIT®
ELECTRIC HOISTS

COVERED BY U. S. AND FOREIGN PATENTS

COVERS MODELS
WITH CATALOG NUMBERS
HAVING 4 DIGITS

MARKETING DIVISION
TOOL GROUP

DRESSER

DRESSER INDUSTRIES, INC.

HOIST PLANT
414 W. BROADWAY, MUSKEGON, MICHIGAN 49443

FOREWORD

This book contains complete replacement parts information for your new BUDGIT Electric Hoist. The parts are grouped and illustrated in exploded view photos to permit easy identification. Each part in an illustration is keyed by reference number to a corresponding parts table. In the table will be found the BH part number, description and quantity required.

This manual also contains parts information pertaining to 'Extra Heavy Duty' hoists (suitable and equipped for plating hoist service). Figures and parts lists indicate parts applicable to 'Extra Heavy Duty' Models. These models are identified by a number suffix (-4, -5) after the hoist catalog number, stamped on the nameplate located on motor. Dash 4 indicates hook suspension, Dash 5 indicates lug suspension.

When ordering replacement parts it will be necessary that you include, with your order, the BH part number of parts required, plus, hoist catalog number and model number, which will be found on the hoist nameplate attached to motor.

It will likely be a long time before this parts information is required, therefore, we suggest that this parts book be care-

fully filed, for future reference, along with the separate "Operation and Service" manual which is also furnished with the hoist.

Complete inspection, maintenance and overhaul service is available for BUDGIT Electric Hoists at any of the Authorized Repair Stations listed on the back cover. All are staffed by qualified factory-trained service men; have authorized testing equipment; and stock a complete inventory of genuine BUDGIT replacement parts.

NOTICE: Information contained in this book is subject to change without notice.

WARNING

EQUIPMENT COVERED HEREIN IS NOT DESIGNED OR SUITABLE AS A POWER SOURCE FOR LIFTING OR LOWERING PERSONS.

INDEX OF EXPLODED VIEW PARTS ILLUSTRATIONS

Figure No.	Title	Page
1.	Frame and External Parts	3
2.	Upper Suspension, Load Chain and Lower Block Parts (2 Ton Capacity Hoists)	6
3.	Upper Suspension, Load Chain and Lower Block Parts (3 Ton Capacity Hoists)	6
4.	Gearing and Load Brake Parts (1/8, 1/4 & 1/2 Ton Capacity Hoists)	7
5.	Gearing and Load Brake Parts (1, 2 & 3 Ton Capacity Hoists)	8
6.	Manual Motor Brake and Electrical Control Parts (Pull Cord Model Hoists)	10
7.	Magnetic Motor Brake Parts (3 Phase, Push Button Model and Extra Heavy Duty Hoists)	11
8.	Magnetic Motor Brake Parts (1 Phase, Push Button Model Hoists—Prior Model No. 325919-1)	12
9.	Magnetic Motor Brake Parts (1 Phase, Push Button Model Hoists Model No. 325919-1 and up)	13
10.	Electrical Control Units (Push Button Model Hoists)	14
11.	Limit Lever and Switch Parts (Push Button Model Hoists)	15
12.	Push Button Station and Conductor Cable Assembly (Standard Models)	16
13.	Push Button Station and Conductor Cable Assembly (Extra Heavy Duty Models)	16
14.	Controller Assembly (Pull Cord Model Hoists)	17
15.	Contacting Assembly (Push Button Model Hoists)	18
16.	2 and 3 Ton Lower Block Assembly (Coil Chain Models Hoists)	20
17.	2 Ton Lower Block Assembly (Roller Chain Models Hoists)	21
18.	Single Phase Motor Assemblies	22
19.	Three Phase Motor Assemblies (Standard Push Button and Pull Cord Model Hoists)	24
20.	Three Phase Motor Assemblies (Extra Heavy Duty Model Hoists)	25
21.	Replacement Motor Chart (Extra Heavy Duty Model Hoists)	25
22.	Replacement Motor Chart (Standard Model Hoists)	26

To enable us to expedite your parts order, always give Model and Catalog Number and Electric Current of Hoist. (See nameplates)

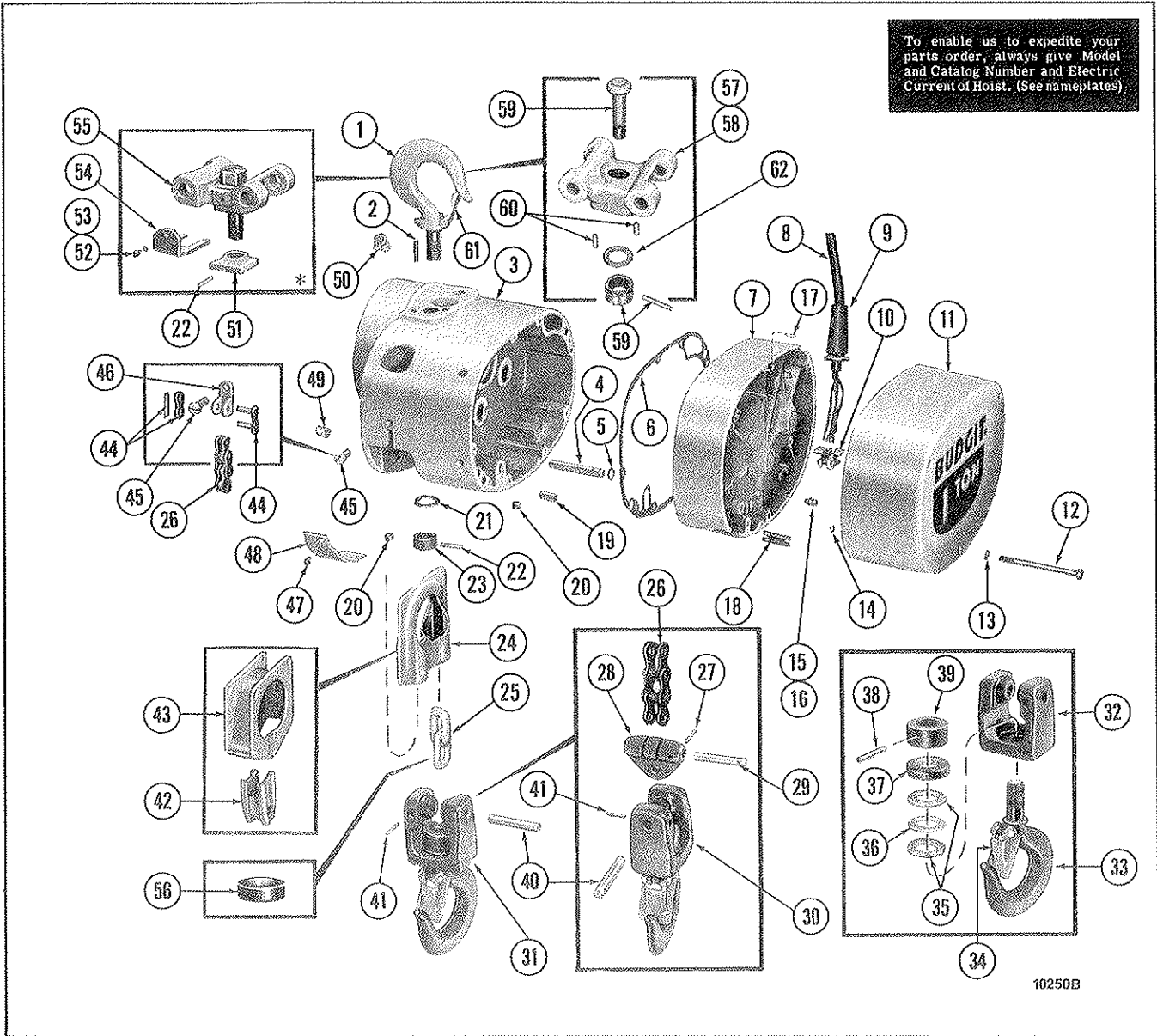

*Used on Models prior to 325079-1; For Replacement see Ref. No. 57

Figure 1. FRAME AND EXTERNAL PARTS – EXPLODED VIEW
Standard & Extra Heavy Duty Hoists (See Pg. 2, Para. 2)
(Except 2 & 3 Ton Model Upper Suspension, Load Chain & Lower Block)

Ref. No.	Part Number	Description	Qty. Req'd.
1	BH-1001	Hook Assembly – Upper with Latch (Includes Items 21, 22, 23 & 61)	1*
2	BH-1002	Pin – Stop, upper hook	1
3	BH-1003	Frame Assembly (For Hoists with Cat. No. prefix letters A, C, E, F, G, H & J. Includes 2 bushings, 1 needle bearing, 1 oil seal, 1 oil filler, 2 pipe plugs, and 2 dowel pins.)	1
	BH-1004	Frame Assembly (For Hoists with Cat. No. prefix letters D, K, L, P, M, S, & T. Includes 2 bushings, 2 needle bearings, 1 oil seal, 1 oil filler, 2 pipe plugs, and 2 dowel pins.)	1
	BH-1081	Frame Assembly (For ¼ & ½ ton capacity Extra Heavy Duty with suffix -4, -5). Includes sealed frame, 2 bushings, 1 needle bearing, 2 oil seals, 1 oil filler, 2 pipe plugs, and 2 dowel pins.	1
	BH-1094	Frame Assembly (For 1 & 2 ton Capacity Extra Heavy Duty with suffix -4, -5). Includes sealed frame, 2 bushings, 2 needle bearings, 2 oil seals, 1 oil filler, 2 pipe plugs, and 2 dowel pins.	1
4	BH-1005	Pin – Support, chain guide	3
5	BH-1006	Gasket – "O" Ring	3
6	BH-1007	Gasket – Gearcase	1

(Continued on following page.)

Figure 1. FRAME AND EXTERNAL PARTS – Continued

Ref. No.	Part Number	Description	Qty. Req'd.
7	BH-1008	Cover Assembly – Gearcase (For Hoists with Cat. No. prefix letters A, C, E, F, G, H & J. Includes 1 needle bearing, 1 cup and 2 groove pins).	1
	BH-1009	Cover Assembly – Gearcase (For Hoists with Cat. No. prefix letters D, K, L, P, M, S & T. Includes 2 needle bearings and 2 groove pins).	1
	BH-1082	Cover Assembly – Gearcase (For ¼ & ½ Ton Capacity Extra Heavy Duty Hoists with suffix (-4, -5). Sealed and includes 1 needle bearing assembly and 2 groove pins.	1
	BH-1095	Cover Assembly – Gearcase (For 1 & 2 ton Capacity Extra Heavy Duty Hoists with suffix (-4, -5). Sealed and includes 2 needle bearing assemblies and 2 groove pins.	1
8		Cable Assembly – Flexible, 5' (Incl. Items 9 & 10)	
	BH-1010	(115 volt, 1 phase, 60 hertz hoists)	1
	BH-1011	(230 volt, 1 phase, 60 hertz hoists)	1
	BH-1012	(208/230/460/575 volt, 3 phase, 60 hertz hoists)	1
9	BH-1013	Grommet – Flexible Cable – 3 phase	1
	BH-1096	Grommet – Flexible Cable – 1 phase	1
10	BH-1014	Clamp – Flexible Cable	1
11		Cover – Electrical Compartment	
	BH-1015	(1/8 ton)	1
	BH-1016	(1/4 ton)	1
	BH-1017	(1/2 ton)	1
	BH-1018	(1 ton)	1
	BH-1019	(2 ton)	1
	BH-1085	(3 ton)	1
12	BH-1020	Screw – Fillister Head Machine	3
13	BH-1021	Lockwasher – Spring Type	3
14	BH-1022	Ring – Retaining	3
15	BH-1023	Lockwasher – Spring Type	8
16	BH-1024	Screw – Hex Socket Head	8
17	BH-1025	Pin – Groove	2
18	BH-1026	Grommet (Pull Cord and Motor Driven Trolley Models)	1
19	BH-1027	Pin – Dowel, gearcase cover	2
20	BH-1028	Plug – Pipe, hex socket, 1/8"	2
21	BH-1029	Washer – Thrust, upper hook	1
22	BH-1030	Pin – Drive	1
23	**	Nut – Upper Hook	1
24		Guide Assembly – Coil Load Chain	
	BH-1031	(1/8, 1/4 & 1/2 ton Capacity Hoists)	1
	BH-1032	(1, 2 & 3 ton Capacity Hoists)	1
25	***	Chain Assembly – Coil, load	
	BH-1033	(1/4" Dia. – 1/8, 1/4 & 1/2 ton Capacity Hoists)	1
	BH-1034	(5/16" Dia. – 1 ton Capacity Hoists)	1*
	BH-1080	(1/4" Dia. – 1/4 & 1/2 ton Extra Heavy Duty Hoists – Cad. Plate)	1
	BH-1086	(5/16" Dia. – 1 ton Extra Heavy Duty Hoist – Cad. Plate)	1
26	***	Chain Assembly – Roller, load	
	BH-1039	(5/8" Pitch - For 1/8, 1/4, and 1/2 ton capacity hoists)	1
	BH-1040	(3/4" Pitch – For 1 ton capacity hoists)	1*
	BH-1075	Repair Link – 5/8" Pitch Roller Chain (not shown)	1
	BH-1076	Repair Link – 3/4" Pitch Roller Chain (not shown)	1
27	BH-1171	Pin – Roll	1
28		Adapter – Roller Load Chain (Incl. Items 27 and 29)	
	BH-1172	(5/8" Pitch for 1/8, 1/4 and 1/2 ton capacity hoists)	1
	BH-1173	(3/4" Pitch for 1 ton capacity hoists)	1*
29	BH-1043	Pin – Adapter, roller load chain (5/8" Pitch)	1
	BH-1044	Pin – Adapter, roller load chain (3/4" Pitch)	1*
30	††	Block Assembly – Lower, complete (Roller chain)	
	BH-1041	(For 1/8, 1/4 and 1/2 ton capacity hoists and includes Items 27, 28, 29, 40 and 41)	1
	BH-1042	(For 1 ton capacity hoists and includes Items 27, 28, 29, 40 and 41)	1*
31	††	Block Assembly – Lower, complete (Coil chain)	
	BH-1035	(For 1/8, 1/4 and 1/2 ton capacity hoists and includes Items 40 and 41)	1
	BH-1036	(For 1 ton capacity hoists and includes Items 40 and 41)	1*
32		Body – Lower Block, coil and roller chain	

(Continued on following page.)

Figure 1. FRAME AND EXTERNAL PARTS — Continued

Ref. No.	Part Number	Description	Qty. Req'd.
33	BH-1174	(1/8, 1/4 and 1/2 ton capacity hoists)	1
	BH-1175	(1 ton capacity hoists)	1*
34	BH-1176	Hook, Nut and Latch Assembly — Lower Block (1/8, 1/4 and 1/2 ton capacity hoists)	1
	BH-1177	(1 ton capacity hoists)	1*
35	BH-1182	Latch Kit — Hook, lower (1/8, 1/4, and 1/2 ton capacity hoists)	1
	BH-1183	(1 ton capacity hoists)	1*
36	BH-1178	Washer — Thrust, needle bearing	2
37	BH-1179	Bearing Assembly — Needle, thrust	1
38	BH-1180	Shield — Bearing	1
39	BH-1181	Pin — Roll	1
40	**	Nut — Hook	1
41	BH-1037	Pin — Connecting, lower block (1/8, 1/4 and 1/2 ton capacity hoists)	1
	BH-1038	(1 ton capacity hoists)	1*
42	BH-1045	Stripper — Roller Chain	1
43	BH-1046	Guide Assembly — Roller Chain (1/8, 1/4 & 1/2 ton Capacity Hoists)	1
	BH-1047	(1 & 2 ton Capacity Hoists)	1
44	BH-1048	Link Assembly — Roller Chain (For connecting tail end of chain only — Must not be used to join chain.) (1/8, 1/4 & 1/2 ton Capacity Hoists)	1
	BH-1049	(1 & 2 ton Capacity Hoists)	1
45	BH-1050	Screw — Fillister Head (Nylock)	1
46	BH-1051	Anchor — Link, roller load chain (1/8, 1/4 & 1/2 ton Capacity Hoists)	1
47	BH-1052	Screw — Fillister Head (Nylock)	1
	BH-1053	Anchor — Link, roller load chain (1/8, 1/4 & 1/2 ton Capacity Hoists)	1
48	BH-1054	(1 & 2 ton Capacity Hoists)	1
49	BH-1055	Screw & Integral Lockwasher — Round Head	2
50	BH-1056	Cover — Brake Opening (Push Button Models Only)	1
51	BH-1057	Bushing — Oilite, control shaft	2
52	BH-1058	Filler Assembly — Oil	1
53	**	Nut — Suspension Bolt	1
54	BH-1059	Screw — Hex Socket Head Cap	1
55	BH-1060	Lockwasher — Spring Type	1
56	BH-1061	Plate — Lock, lug suspension	1
57	†	Bracket Assembly (1/8, 1/4, 1/2 & 1 ton Capacity Hoists)	1*
58	BH-1063	Bumper — Lower Block (for all hoists having a 64 f.p.m. lifting speed and Push Button Models with single phase motors and 32 f.p.m. lifting speeds)	1
59	905421	Kit — Suspension Lug (Includes Items 58, 59 & 60)	1
60	BH-1087	Bracket — Suspension	1
61	BH-1088	Stud — Suspension, nut and pin (Includes item 62)	1
62	BH-1089	Pin — roll	2
	BH-1183	Latch Kit — Hook (upper) 1/8 thru 1 ton	1
	BH-1092	Washer (.0747 Thk.)	1
	BH-1097	Washer (.1345 Thk.)	As Req'd.

* Refer to Figure 2 for 2 Ton Model Upper Suspension, Load Chain and Lower Block Parts.
Refer to Figure 3 for 3 Ton Model Upper Suspension, Load Chain and Lower Block Parts.

** Hook and suspension bolt nuts are not serviced separately. They are available only with hook or bolt as assemblies.

*** Load Chain Assemblies listed are for hoists with standard 10 ft. lifts. Bulk chain is available in 1 ft. lifts. Bulk chain is available in 1 ft. increments and 50 ft. lengths as follows:

Type Chain	50' Lengths	Bulk
Roller (5/8" Pitch)	BH-1064	BH-1065
Roller (3/4" Pitch)	BH-1067	BH-1068
Coil (1/4" Dia.)	Not Available	BH-1066
Coil (5/16" Dia.)	Not Available	BH-1069
Coil (1/4" Dia. cad.plate)	Not Available	BH-1083
Coil (5/16" Dia. cad.plate)	Not Available	BH-1093

† For suspension bracket assembly replacement use Ref. No. 57.

†† Improved lower block design illustrated went into production in April, 1973 and will be furnished as replacement for older style lower blocks.

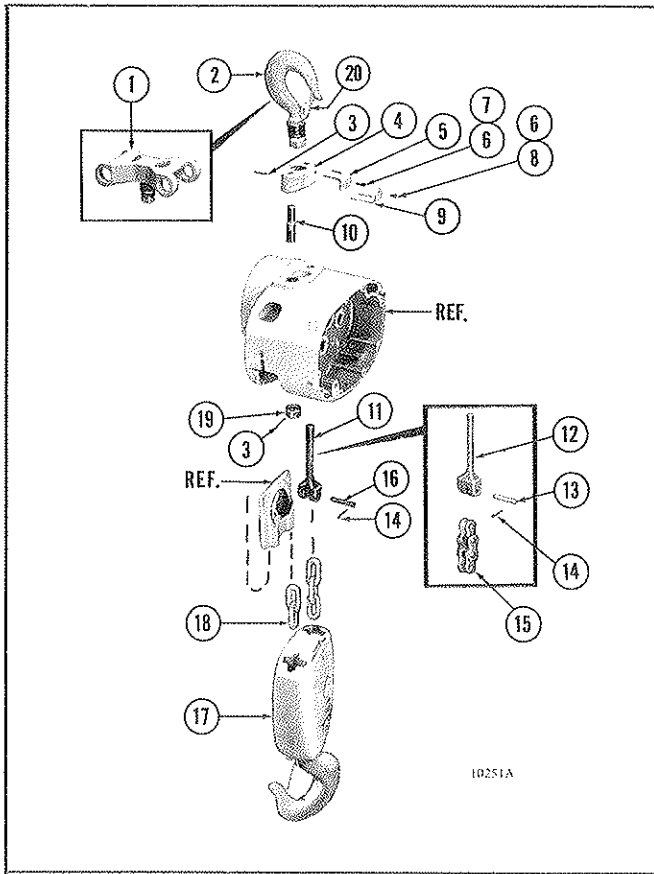

Figure 2. UPPER SUSPENSION,
LOAD CHAIN AND LOWER BLOCK PARTS -- EXPLODED VIEW
(2 Ton Capacity Hoists)

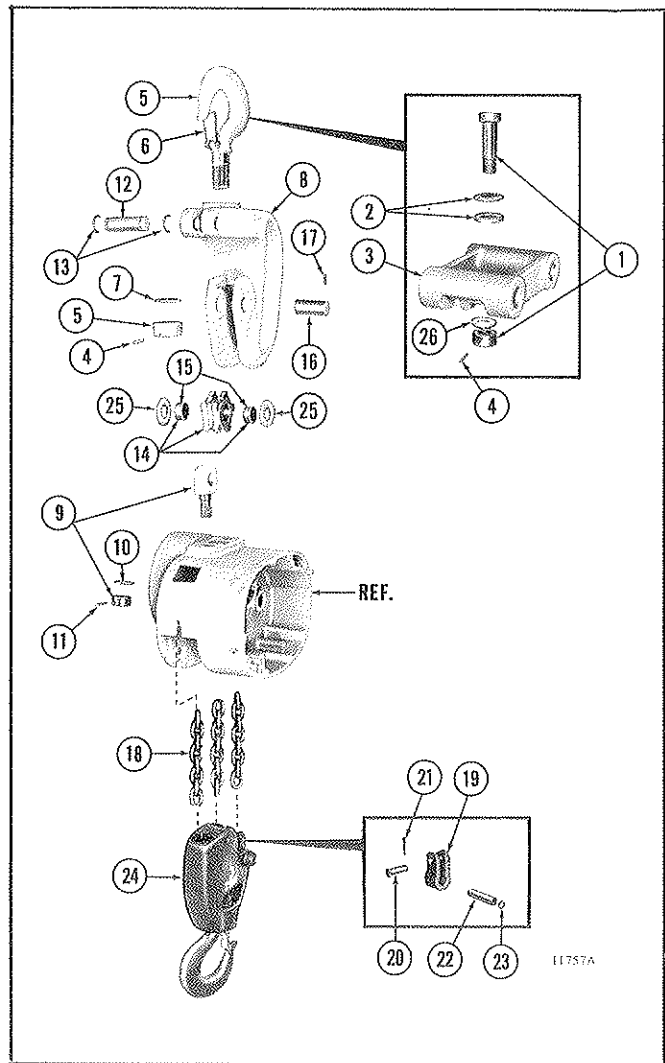

Figure 3. UPPER SUSPENSION, LOAD CHAIN AND LOWER BLOCK PARTS
(3 Ton Capacity Hoists)

Ref. No.	Part Number	Description	Qty. Req'd.
1	905422	Bracket Assembly Kit -- Lug Suspension (Coil Chain Model Only. Includes Items 6, 8 & 9).	1
2	BH-1102	Hook Assembly -- Upper (Includes Items 5, 6, 7, & 20)	1
3	BH-1030	Pin -- Drive	3
4	BH-1104	Block Assembly -- Upper (Coil Chain Models, Includes Items 3, 10, 11, 14, 16, 19 & 21)	1
	BH-1105	(Roller Chain Models, Includes Items 3, 10, 12, 13, 14, 19 & 21)	1
5	BH-1106	Lock Assembly -- Suspension Bushing	1
6	BH-1107	Lockwasher -- Shakeproof, Internal	3
7	BH-1108	Screw -- Hex Socket Head	2
8	BH-1109	Screw -- Hex Socket Head	1
9	BH-1061	Plate -- Lock (Coil Chain Lug Suspension Models Only)	1
10	*	Stud -- Upper Block	1
11	*	Anchor -- Coil Load Chain	1
12	*	Anchor -- Roller Load Chain	1
13	BH-1110	Pin -- Roller Chain Anchor	1
14	BH-1111	Pin -- Cotter	1
15**	BH-1112	Chain Assembly -- Roller Load (3/4" Pitch)	1
	BH-1076	Repair Link -- 3/4" Pitch Roller Chain (Not Shown)	As Req'd.
16	BH-1113	Pin -- Coil Chain Anchor	1
17	(See Fig. 13)	Block Assembly -- Lower (Coil Chain Models)	1
	(See Fig. 14)	Block Assembly -- Lower (Roller Chain Models)	1
18**	BH-1114	Chain Assembly -- Coil Load	1
	BH-1115	Chain Assembly -- Coil Load (Cad. Plated) Extra Heavy Duty Hoists	1
19	*	Nut -- Upper Block Stud	1
20	BH-2213	Latch Kit -- Hook	1
21	BH-1029	Washer -- Thrust (Not illustrated -- use with Ref. No. 19)	1

* Not available as individual parts. Order upper block assembly, Item 4.

** Load Chain Assemblies listed are for hoists with standard 10 ft. lifts. Bulk chain is available in 1 ft. increments and 50 ft. lengths as follows:

Type Chain	50' Lengths	Bulk
Roller (3/4" Pitch)	BH-1067	BH-1068
Coil (5/16" Dia.)	Not Available	BH-1069
Coil (5/16" Dia. cad. plate)	Not Available	BH-1093

Ref. No.	Part Number	Description	Qty. Req'd.
1	BH-1131	Suspension Pin & Nut Assem.	1
2	BH-1132	Spherical Washer	1 Pr.
3	905424	Suspension Lug Kit (Includes Items 1, 2, 4 & 26)	1
4	BH-1134	Pin -- Grooved	1
5	BH-1135	Hook/Latch & Nut (Includes Item 6)	1
6	BH-2214	Latch Kit, Hook	1
7	BH-2217	Washer, Thrust	1
8	BH-1138	Hanger	1
9	BH-1139	Connecting Rod Assem.	1
10	BH-1029	Washer, Thrust	1
11	BH-1030	Pin, Grooved	1
12	BH-1142	Pin, Connection	1
13	BH-1143	Ring, Retaining	2
14	BH-1144	Sprocket & Bushing Assem. (Includes Item 15)	1
15	BH-1145	Bushing	2
16	BH-1146	Pin, Sprocket	1
17	BH-1147	Pin, Grooved	1
18	BH-1148	Chain Assembly, Coil Load	1
19	BH-1149	Link, Connecting	1
20	BH-1150	Pin, Anchor	1
21	BH-1151	Pin, Cotter	1
22	BH-1152	Pin, Dowel	1
23	BH-1153	Ring, Retaining	1
24	(See Fig. 16)	Block Assembly, Lower, Coil Chain	1
25	BH-2210	Washer, Thrust	2
26	BH-1154	Washer	1

NOTICE

Always insist on genuine BUDGIT Hoist replacement parts when servicing this equipment. Parts are available from your local Authorized Repair Station or the factory at Muskegon.

To enable us to expedite your parts order, always give Model and Catalog Number and Electric Current of Hoist. (See nameplates)

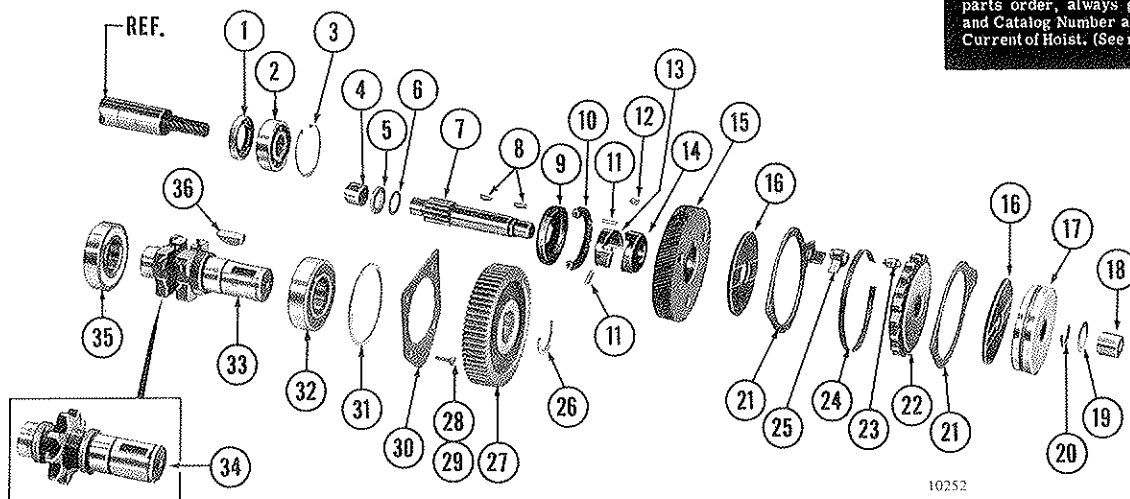

Figure 4. GEARING AND LOAD BRAKE PARTS – EXPLODED VIEW
 1/8, 1/4 & 1/2 Ton Capacity Standard Hoists and
 1/4 & 1/2 Ton Capacity Extra Heavy Duty Hoists (See Pg. 2, Para. 2)

Ref. No.	Part Number	Description	Qty. Req'd.
1	BH-1201	Seal – Oil, motor shaft	1
2	BH-1202	Bearing Assembly – Ball, motor shaft	1
3	BH-1203	Ring – Retaining, Internal	1
4	BH-1237	Bearing Assembly – Needle, 11/16" I.D. (36 rollers, grease retained)	1
5	BH-1205	Bearing – Thrust, bronze	1
6	BH-1206	Washer – Thrust, 11/16" I.D. (Used with 14 tooth Pinion Load Brake Shaft – BH-1207 below)	1
7	BH-1207	Shaft & Integral Pinion – load brake, 14 teeth	1
	BH-1208	23 teeth	1
	BH-1209	36 teeth	1
8	BH-1210	Key – Woodruff	2
9	BH-1211	Retainer – Spring, load brake	1
10	BH-1212	Spring – load brake (Plain – no color code)	1
	BH-1213	Spring – load brake (Yellow color code)	1
11	BH-1214	Pin – Groove	2
12	BH-1215	Key – Woodruff	1
13	BH-1216	Cam – load brake	1
14	*	Gear Center – load brake	1
15	BH-1217	Gear & Center Assembly – load brake	1
16	BH-1218	Disc – Friction, load brake	2
17	BH-1219	Flange – load brake	1
18	BH-1220	Bearing Assembly – Needle, 5/8" I.D.	1
19	BH-1221	Washer – Thrust, 5/8" I.D.	1
20	BH-1222	Ring – Snap, brake flange	1
	BH-1223	Pawl & Ratchet Assembly – load brake	1
21	**	Plate – Side	2
22	**	Ratchet	1
	**	Bushing – Ratchet (Not Shown)	2
23	**	Rivet – Spacer	1
24	**	Spring – Pawl	1
25	**	Pawl	1
26	BH-1224	Ring – Snap, sprocket gear	1
27		Gear – Sprocket	
	BH-1225	74 teeth	1
	BH-1226	65 teeth	1
	BH-1227	52 teeth	1

Figure 4. GEARING AND LOAD BRAKE PARTS – Continued

Ref. No.	Part Number	Description	Qty. Req'd.
28	BH-1228	Screw – Fillister Head Machine	4
29	BH-1229	Lockwasher – Spring Type	4
30	BH-1230	Plate – Retainer, sprocket bearing	1
31	BH-1231	Gasket – Ring, sprocket bearing	1
32	BH-1232	Bearing Assembly – Ball, sprocket	1
33	BH-1233	Sprocket – Coil chain (1/4" Dia. Wire)	1
34	BH-1234	Sprocket – Roller chain (5/8" Pitch)	1
35	BH-1235	Bearing Assembly – Ball, sprocket	1
36	BH-1236	Key – Woodruff	1

* Not available as an individual part. Order Gear and Center Assembly.

** Not available as individual parts. Order Pawl and Ratchet Assembly.

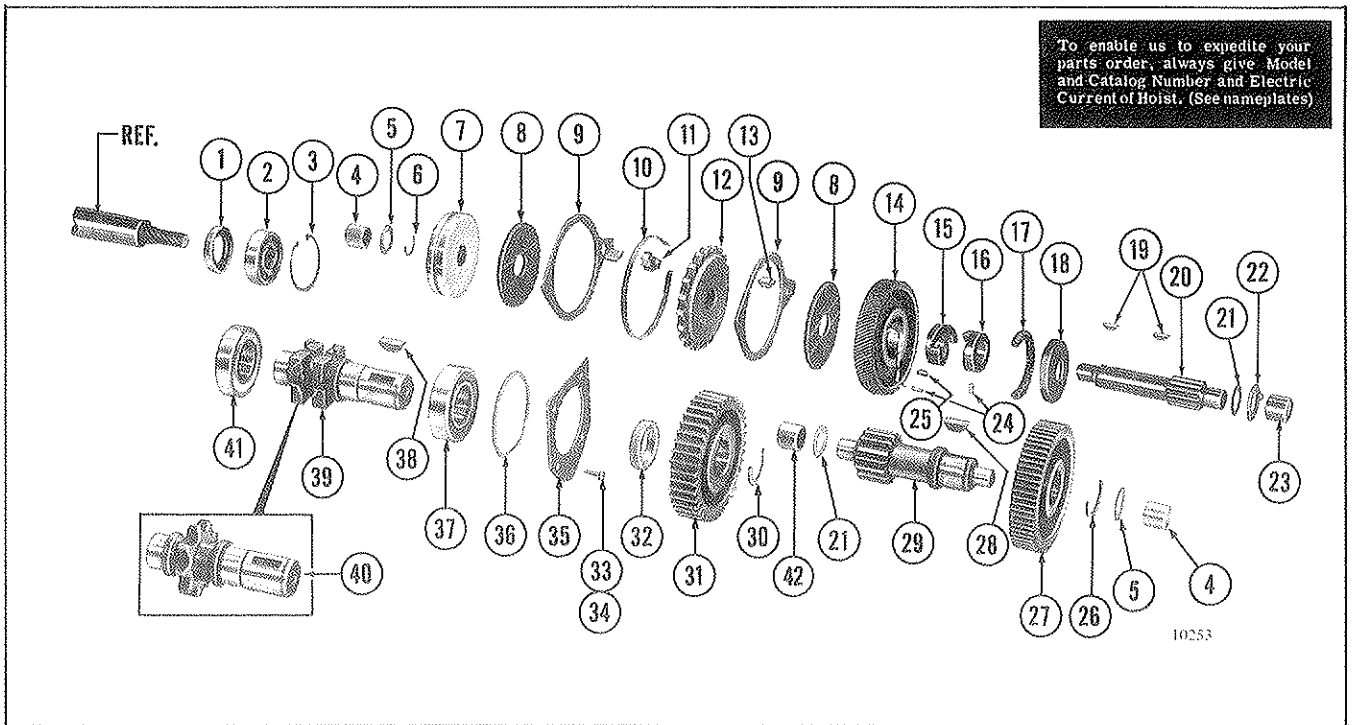

Figure 5. GEARING AND LOAD BRAKE PARTS – EXPLODED VIEW

(1, 2 & 3 Ton Capacity Hoists)

(1 & 2 Ton Capacity Extra Heavy Duty Hoists) (See Pg. 2, Para. 2)

Ref. No.	Part Number	Description	Qty. Req'd.
1	BH-1201	Seal – Oil, motor shaft	1
2	BH-1202	Bearing Assembly – Ball, motor shaft	1
3	BH-1203	Ring – Retaining, Internal	1
4	BH-1220	Bearing Assembly – Needle, 5/8" I.D.	2
5	BH-1221	Washer – Thrust, 5/8" I.D.	2
6	BH-1222	Ring – Snap, brake flange	1
7	BH-1219	Flange – Load Brake	1
8	BH-1218	Disc – Friction, load brake	2
	BH-1223	Pawl & Ratchet Assembly – Load Brake	1
9	*	Plate – Side	2
10	*	Spring – Pawl	1
11	*	Pawl	1
12	*	Ratchet	1
	*	Bushing – Ratchet (Not Shown)	1
13	*	Rivet – Spacer	2

Figure 5. GEARING AND LOAD BRAKE PARTS – Continued

Ref. No.	Part Number	Description	Qty. Req'd.
14	BH-1217	Gear & Center Assembly – Load Brake	1
15	**	Gear Center – Load Brake	1
16	BH-1216	Cam – Load Brake	1
17	BH-1212	Spring – Load Brake (Plain – no color code)	1
18	BH-1211	Retainer – Spring, Load Brake	1
19	BH-1210	Key – Woodruff	2
20		Shaft & Integral Pinion – Load Brake	
	BH-1207	14 teeth	1
	BH-1208	23 teeth	1
21	BH-1206	Washer – Thrust, 11/16 I.D.	2
22	BH-1205	Bearing – Thrust, bronze	1
23	BH-1204	Bearing Assembly – Needle, 11/16" I.D.	1
24	BH-1214	Pin – Groove	2
25	BH-1215	Key – Woodruff	1
26	BH-1224	Ring – Snap, intermediate gear	1
27		Gear – Intermediate	
	BH-1225	74 teeth	1
	BH-1226	65 teeth	1
28	BH-1236	Key – Woodruff	1
29	BH-1304	Shaft & Integral Pinion – Intermediate	1
30	BH-1305	Ring – Snap, sprocket gear	1
31	BH-1306	Gear – Sprocket	1
32	BH-1307	Spacer – Sprocket Gear	1
33	BH-1228	Screw – Fillister Head Machine	4
34	BH-1229	Lockwasher – Spring Type	4
35	BH-1230	Plate – Retainer, sprocket bearing	1
36	BH-1231	Gasket – Ring, sprocket bearing	1
37	BH-1232	Bearing Assembly – Ball, sprocket	1
38	BH-1308	Key – Woodruff, sprocket	1
39	BH-1309	Sprocket – Coil Chain	1
40	BH-1310	Sprocket – Roller Chain	1
41	BH-1235	Bearing Assembly – Ball, sprocket	1
42	BH-1237	Bearing Assembly – Needle, 11/16" I.D. (36 roller, greased retained)	1

* Not available as individual parts. Order Pawl and Ratchet Assembly.
 ** Not available as an individual part. Order Gear and Center Assembly.

NOTES

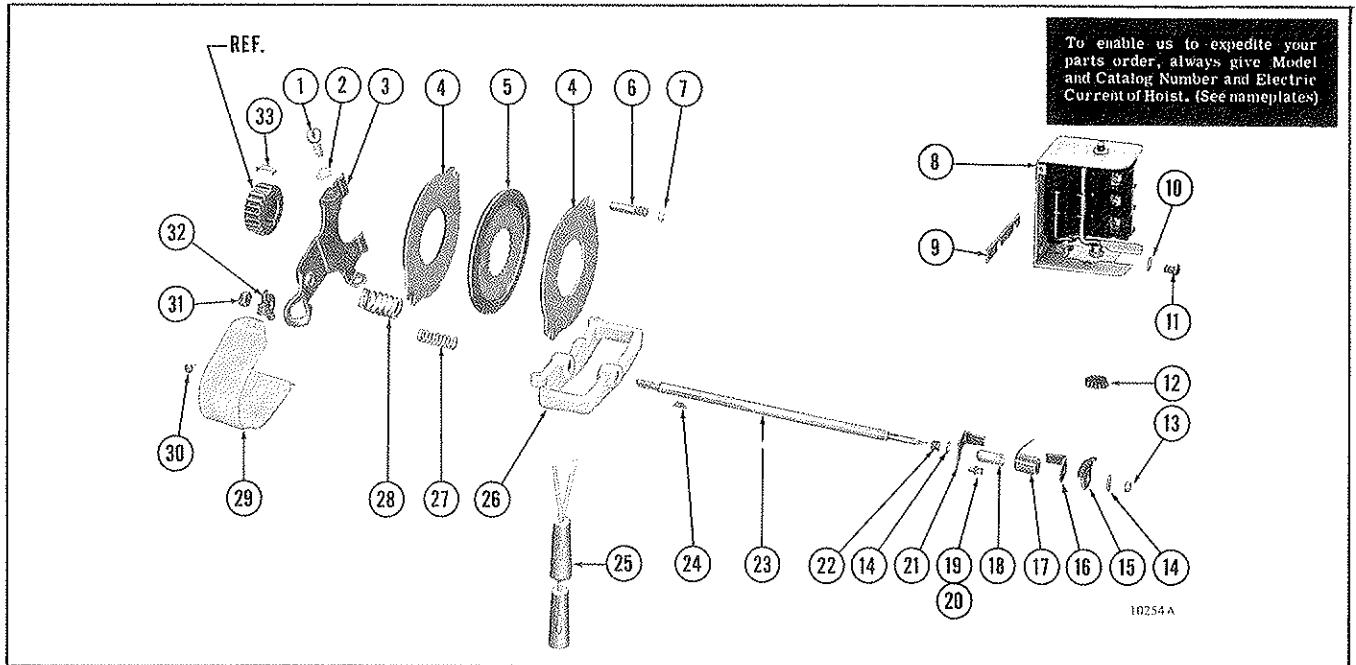

Figure 6. MANUAL MOTOR BRAKE AND ELECTRICAL CONTROL PARTS – EXPLODED VIEW
(Pull Cord Model Hoists)

Ref. No.	Part Number	Description	Qty. Req'd.
1	BH-1401	Pin – Pivot, brake lever	2
2	BH-1402	Lockwasher	2
3	BH-1403	Lever – Compression, brake	1
4	BH-1404	Plate – Friction, brake	2
5	BH-1405	Disc Assembly – Friction, brake	1
6	BH-1406	Pin – Support, brake plate	2
7	BH-1407	Ring – Retaining	2
8	(See Fig. 14)	Controller Assembly (Includes Items 12 and 13)	1
9	BH-1408	Shim – Controller (.0209" thk.)	As Req'd.
	BH-1409	Shim – Controller (.0149" thk.)	As Req'd.
10	BH-1410	Lockwasher – Spring Type	3
11	BH-1411	Screw – Round Head Machine	3
12	(See Fig. 14)	Pinion – Controller	1
13*	BH-1413	Nut – Hex, self locking	1
14*	BH-1414	Washer – Spacer	2
15*	BH-1415	Gear Segment – Controller	1
16*	BH-1416	Lever – Centering, controller	1
17*	BH-1417	Spring – Centering, controller	1
18*	BH-1418	Tube – Spacer	1
19	BH-1419	Screw – Hex Socket Head	2
20	BH-1420	Lockwasher – Spring Type	2
21*	BH-1421	Retainer – Centering Spring	1
22*	BH-1422	Bearing – Flanged Sleeve	1
23*	BH-1423	Shaft – Control	1
24	BH-1424	Key – Woodruff	1
25	BH-1425	Cord Assembly – Control	1
	BH-1426	Handle – Control "UP"	1
	BH-1427	Handle – Control "DOWN"	1
26	BH-1428	Lever – Limit	1
27	BH-1429	Spring – Brake Cam	1
28	BH-1430	Spring – Brake	1
29	BH-1431	Cover – Brake Lever	1
30	BH-1432	Screw & Integral Lockwasher – Round Head	2
31	BH-1433	Nut – Hex, self locking	1
32	BH-1434	Cam – Brake	1
33	BH-1435	Spring – Friction Disc	1

* Above parts available as an assembly. Order No. BH-1436.

To enable us to expedite your parts order, always give Model and Catalog Number and Electric Current of Hoist. (See nameplates)

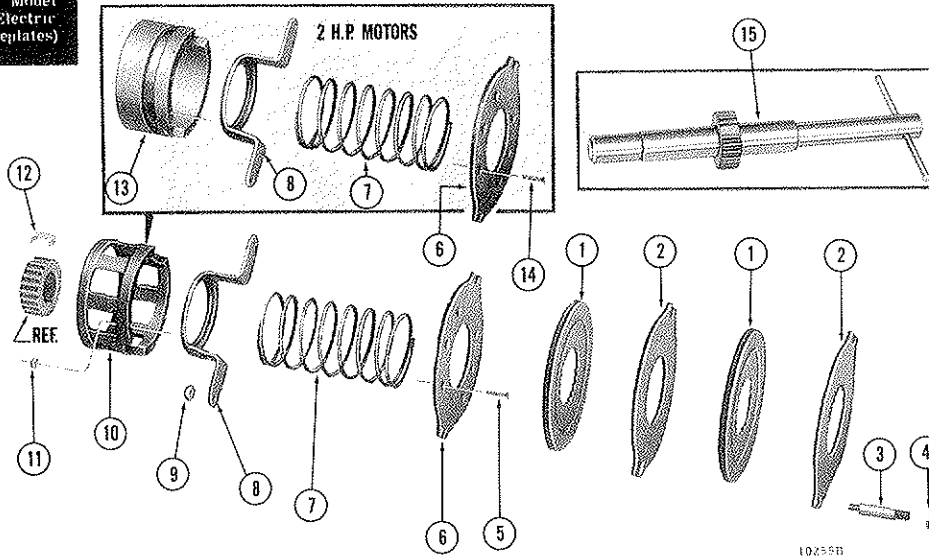

Figure 7. MAGNETIC MOTOR BRAKE PARTS — EXPLODED VIEW
(3 Phase, Push Button Model Hoists & Extra Heavy Duty Hoists) (See Pg. 2, Para 2)

Ref. No.	Part Number	Description	Qty. Req'd.
1	BH-1405	Disc Assembly — Friction	2
2	BH-1404	Plate — Friction	2
3	BH-1501	Pin — Support, plate	2
4	BH-1407	Ring — Retaining	2
5	BH-1502	Screw — Flat Socket Head	6
6	*	Plate — Compression	1
7	BH-1504	Spring — Compression (1/4 & 1/2 H.P. Motors)	1
	BH-1505	Spring — Compression (1 & 2 H.P. Motors)	1
8	*	Cage — Spring	1
9	BH-1507	Nut — Hex, self locking	2
10	*	Plunger	1
11	BH-1509	Nut — Hex, self locking	6
12	BH-1435	Spring — Friction Disc (Not used on Extra Heavy Duty Hoists)	1
13	*	Plunger (2 H.P. Motor)	1
14	BH-1510	Screw — Flat Head (2 H.P. Motor)	6
15	224704-1	Tool — Brake Disc Alignment	1

*These items not available separately (for assemblies see below)

BH-1511 Cage & Plunger Assem. (Includes items 5, 6, 8, 10 & 11)

BH-1512 Cage & Plunger Assem. (Includes items 6, 8, 13 & 14) — 2 HP

NOTES

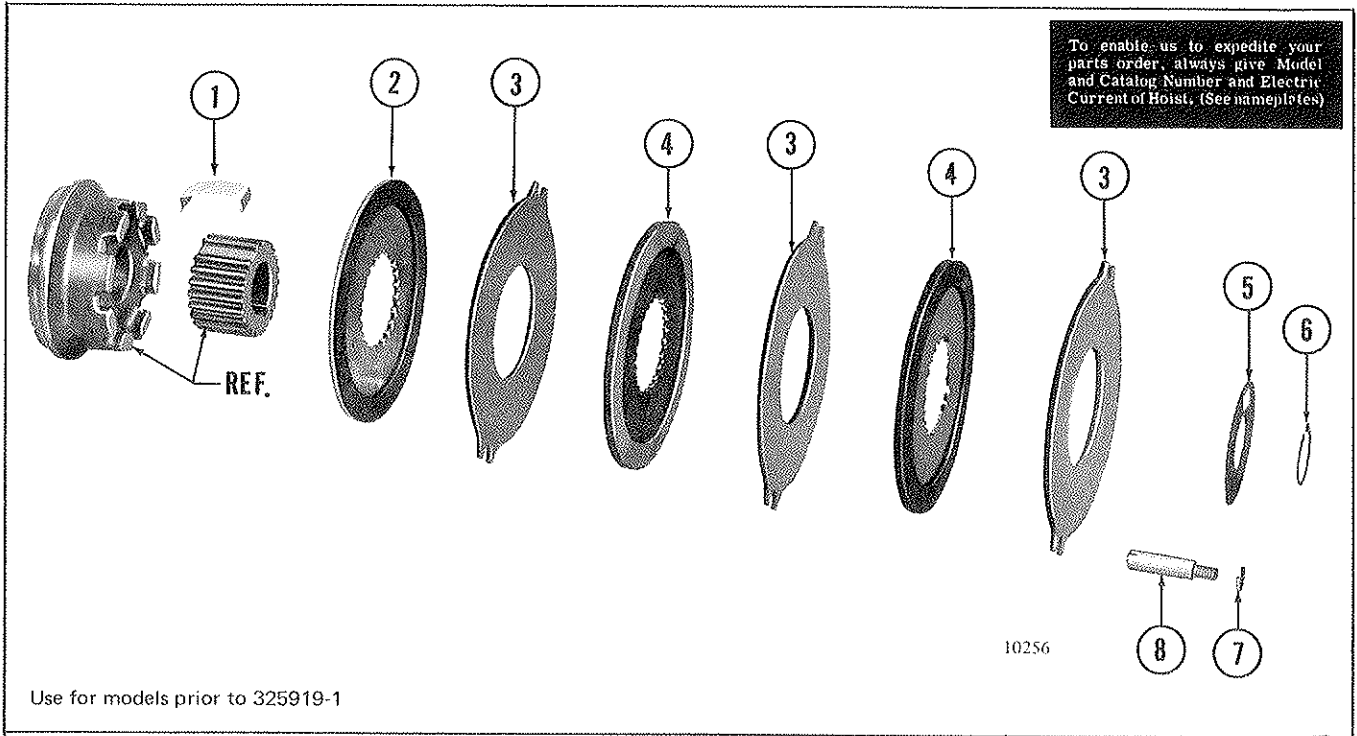

Figure 8. MAGNETIC MOTOR BRAKE PARTS – EXPLODED VIEW
(Single Phase, Push Button Model Hoists)

Ref. No.	Part Number	Description	Qty. Req'd.
1	BH-1601	Spring – Friction Disc	1
2	BH-1602	Disc Assembly – Brake	1
3	BH-1404	Plate – Friction	3
4	BH-1405	Disc Assembly – Friction	2
5	BH-1603	Washer – Retainer	1
6	BH-1604	Ring – Retaining	1
7	BH-1407	Ring – Retaining	2
8	BH-1605	Pin – Support, plate	2

NOTICE

Always insist on genuine BUDGIT Hoist replacement parts when servicing this equipment. Parts are available from your local Authorized Repair Station or the factory at Muskegon.

NOTES

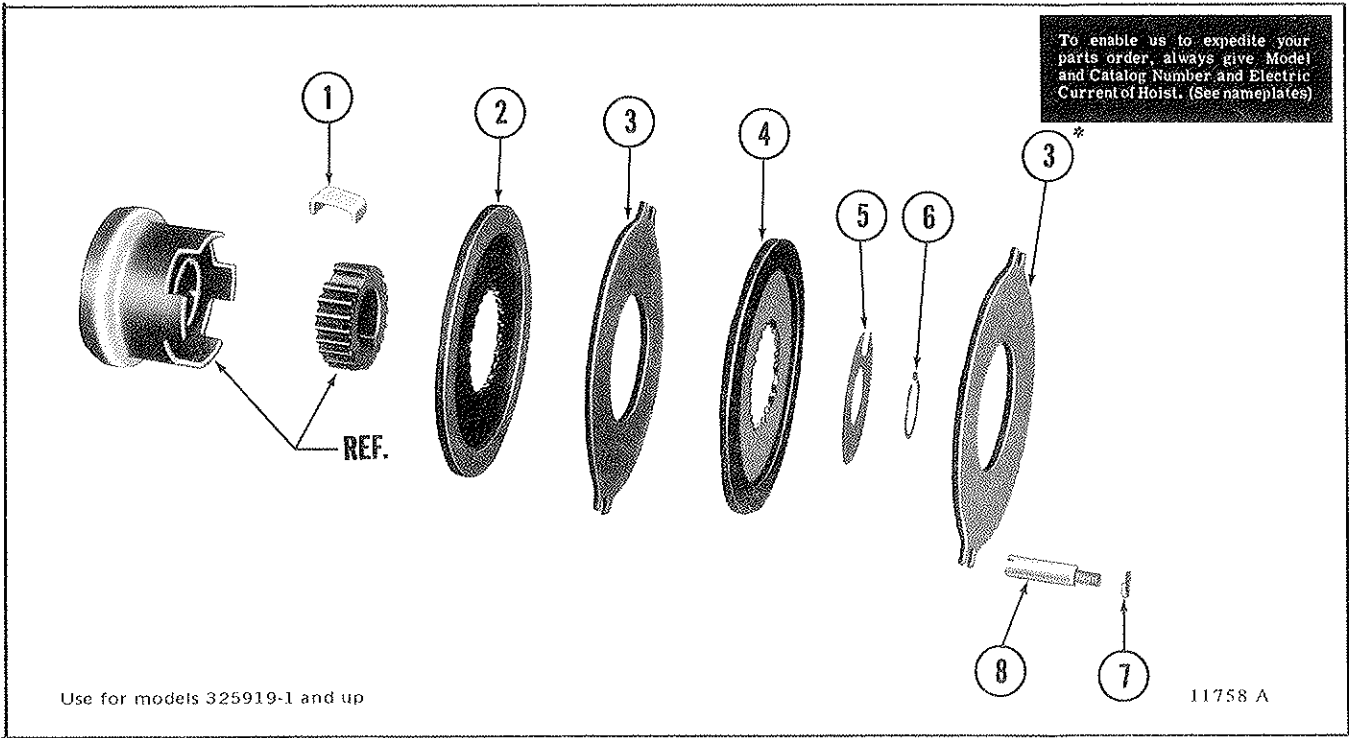

Figure 9. MAGNETIC MOTOR BRAKE PARTS
(Single Phase, Push Button Model Hoists)

Ref. No.	Part Number	Description	Qty. Req'd.
1	BH-1435	Spring, Friction Disc.	1
2	BH-1610	Disc Assembly – Brake	1
3	BH-1404	Plate – Friction	2
4	BH-1405	Disc Assembly – Friction	1
5	BH-1611	Washer – Retainer	1
6	BH-1604	Ring – Retaining	1
7	BH-1407	Ring – Retaining	2
8	BH-1605	Pin – Support, brake plate	2

*Above plate not mounted on splined hub, it lies loose over support pins in frame.

NOTES

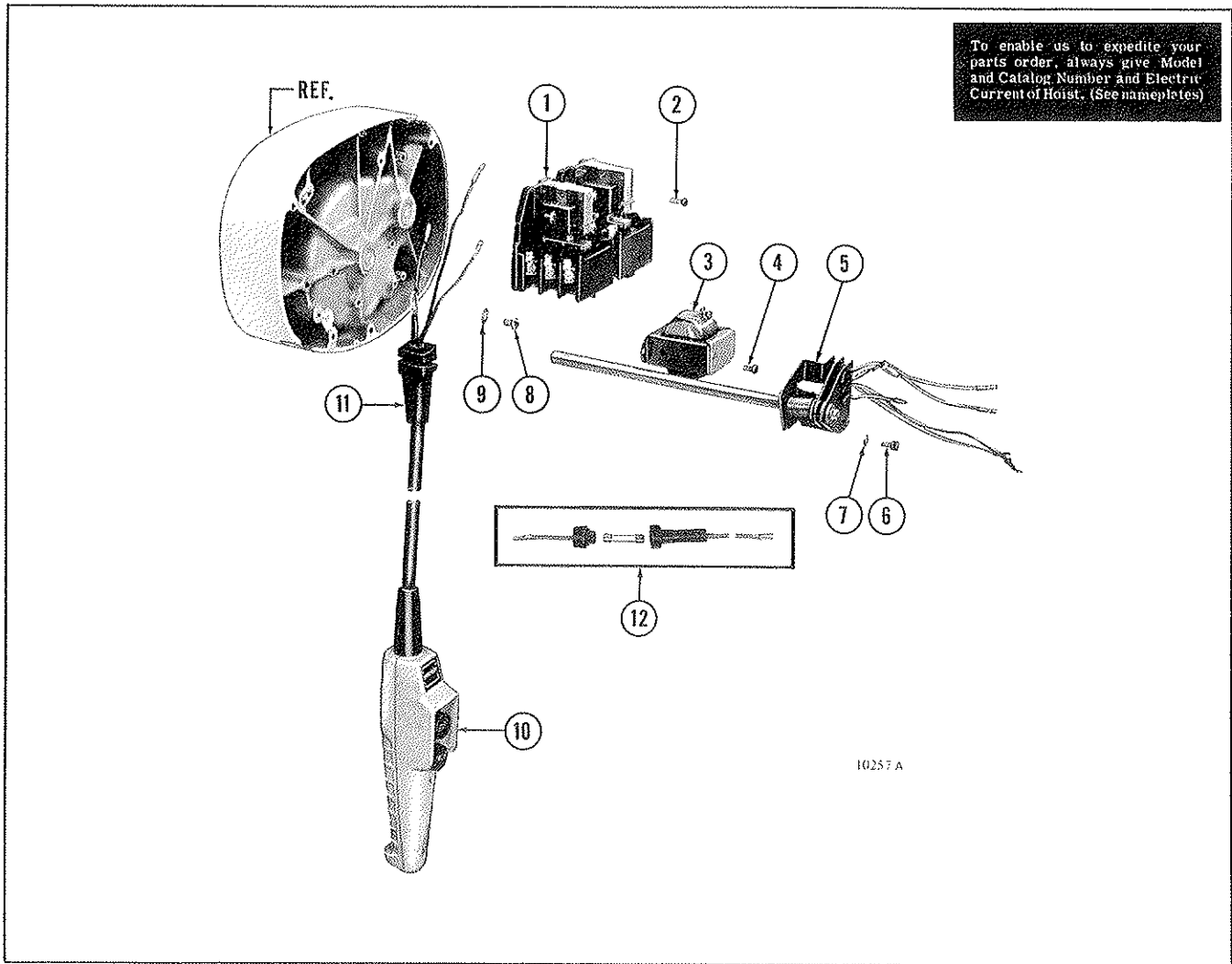

Figure 10. ELECTRICAL CONTROL UNITS – EXPLODED VIEW
 (Push Button Model Hoists)
 (Standard & Extra Heavy Duty Hoists) (See Pg. 2, Para. 2)

Ref. No.	Part No. Standard Hoist 24 v. Coil	Part No. Extra Heavy Duty Hoist 115 v. Coil	Description	Qty. Req'd.
1	(See Fig. 15)	(See Fig. 15)	Contactor Assembly – Complete	1
2	BH-1701	BH-1701	Screw & Integral Lockwasher – Round Head	2
3	BH-1702	BH-1715	Transformer Assembly (208 volt, 3 phase, 60 hertz hoists)	1
	BH-1703	BH-1716*	(230 volt, 1 & 3 phase, 60 hertz hoists)	1
	BH-1704	BH-1717	(460 volt, 3 phase, 60 hertz hoists)	1
	BH-1705	BH-1718	(575 volt, 3 phase, 60 hertz hoists)	1
	BH-1706		(115 volt, 1 phase, 60 hertz hoists)	1
	BH-1707	BH-1719	(230/460 volt, reconnectable hoists)	1
4	BH-1708	BH-1708	Screw & Integral Lockwasher – Round Head	2
5	(See Fig. 11)	(See Fig. 11)	Switch & Shaft Assembly – Limit	1
6	BH-1709	BH-1709	Screw – Hex Socket Head	2
7	BH-1710	BH-1710	Lockwasher	2
8	BH-1711	BH-1711	Screw – Round Head Machine	1
9	BH-1712	BH-1712	Washer – Flat	2
10	(See Fig. 12)	(See Fig. 13)	Push Button Station & Conductor Cable Assembly	1
11	BH-1713	BH-1713	Grommet – Strain Reliever, upper	1
12	(See Fig. 11)	(See Fig. 11)	Fuse, Fuse Holder and Wire Assembly	1

* 3 Phase Only

To enable us to expedite your parts order, always give Model and Catalog Number and Electric Current of Hoist. (See nameplates)

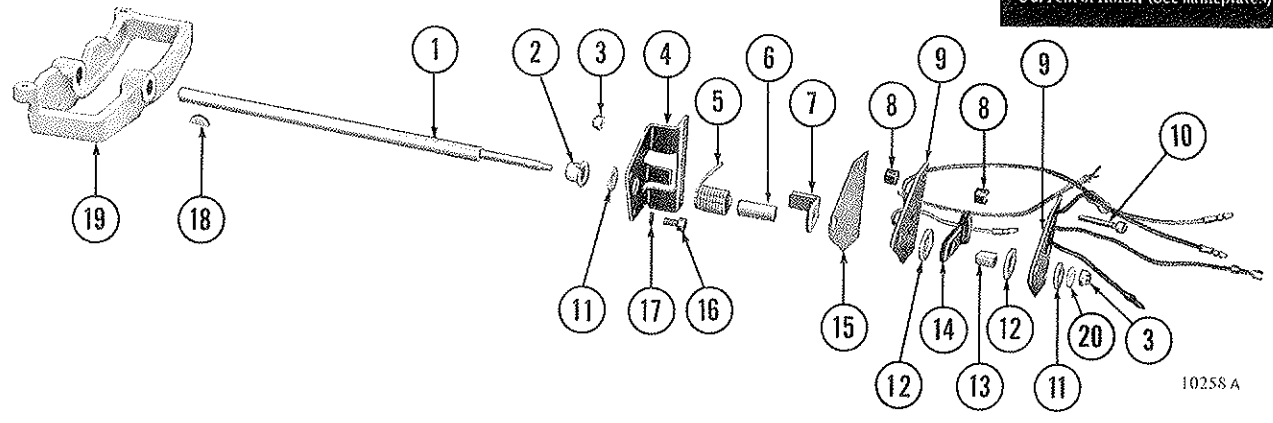

Figure 11. LIMIT LEVER AND SWITCH PARTS – EXPLODED VIEW
(Push Button Model Hoists & Extra Heavy Duty Models) (See Pg. 2, Para. 2)

Ref. No.	Part Number	Description	Qty. Req'd.
		Switch & Shaft Assembly – Limit	
	BH-1801	For Use with 115V. w/o Transformer (Includes Items 1, 3 thru 15 & 21)	1
	BH-1820	For Use with 115V. Trans. Secondary (Includes Items 1, 3 thru 15 & 22)	1
	BH-1821	For Use with 24V. Trans. Secondary (Includes Items 1, 3 thru 15 & 23)	1
1	BH-1802	Shaft – Control	1
2	BH-1422	Bearing – Flanged Sleeve	1
3	*	Nut – Hex, self locking	3
4	*	Bracket – Retainer	1
5	BH-1417	Spring – Centering	1
6	*	Tube – Spacer	1
7	*	Lever – Centering	1
8	*	Spacer	4
9	BH-1810	Contact Board & Wire Assembly – Limit Switch (Includes item 21)	1
10	*	Screw – Round Head Cap	2
11	*	Washer – Spacer	2
12	*	Washer – Spacer, contact slide arm	2
13	*	Spacer – Drive, contact slide arm	1
14	BH-1815	Arm Assembly, contact slide	1
15	*	Insulation Strip	1
16	BH-1419	Screw – Hex Socket Head	2
17	BH-1420	Lockwasher – Spring Type	2
18	BH-1424	Key – Woodruff	1
19	BH-1428	Lever – Limit	1
20	BH-1819	Washer – Flat	1
21	BH-1822	Jumper Wire Assem. – 115 volt without Transformer (not illustrated)	1
**22	BH-1823	Fuse, Fuse Holder and Wire Assem. (w/1A. Fuse) for 115V. Transformer	1
**23	BH-1824	Fuse, Fuse Holder and Wire Assem. (w/5A. Fuse) for 24V. Transformer	1

Note: Replacement fuses are standard automotive type and should be purchased locally.

*Furnished only with limit switch and shaft assembly.
**See Fig. 10 for illustration.

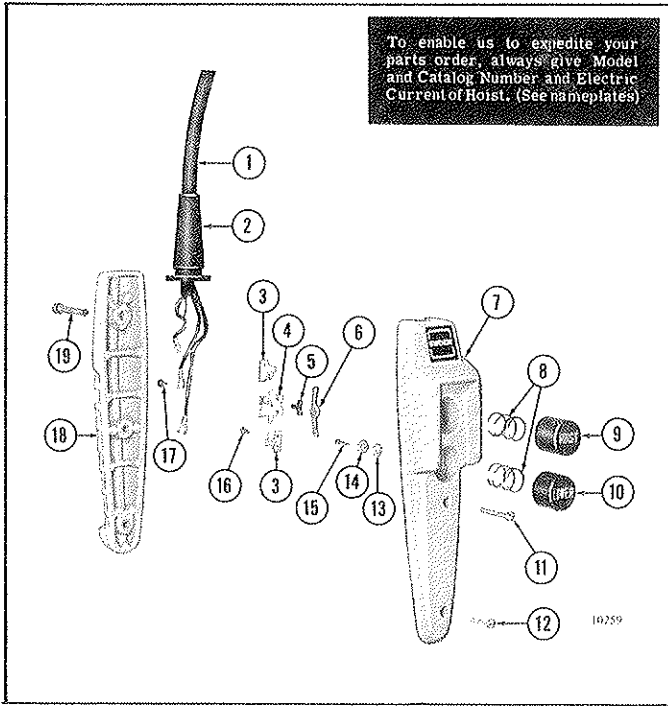

Figure 12. PUSH BUTTON STATION & CONDUCTOR CABLE ASSEMBLY
— EXPLODED VIEW
(Standard Model Hoists)

Ref. No.	Part Number	Description	Qty. Req'd.
*	BH-1901	Push Button Station & Conductor Cable Assembly	1
1*	BH-1902	Cable Assembly — Conductor, flexible (Includes upper and lower grommets)	1
2	BH-1903	Grommet — Strain Reliever, lower	1
	BH-1904	Station Assembly — Push Button (Includes Items 3 thru 19)	1
3	..	Contact — Stationary	2
4	..	Contact — Stationary, center	1
5	..	Retainer — Interlock Bar	2
6	..	Bar — Interlock	2
7	BH-1909	Body Assembly — Front Half (Includes Item 18)	1
8	BH-1910	Spring — Push Button	2
9	BH-1911	Button — Push, "HOIST"	1
10	BH-1912	Button — Push, "LOWER"	1
11	BH-1913	Screw — Fillister Head Machine	1
12	BH-1914	Screw — Fillister Head Machine	1
13	..	Spring — Contact	2
14	..	Contact — Movable	2
15	..	Screw — Shoulder	2
16	..	Screw — Round Head Machine	6
17	..	Screw — Pan Head Machine, plated	3
18	BH-1920	Body Assembly — Rear Half (Includes Item 7)	1
19	BH-1921	Screw — Fillister Head Machine	1

* These assemblies are for standard 10' lift hoists. When ordering replacements for hoists with other than standard lifts, specify lift.

** These parts not available separately.
Order Contact Kit — BH-1922

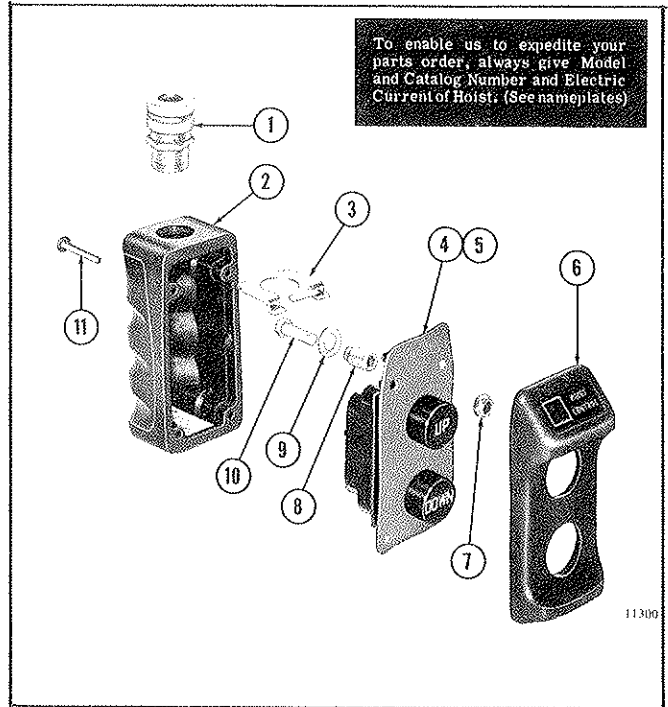

Figure 13. PUSH BUTTON STATION & CONDUCTOR CABLE ASSEMBLY
(Extra Heavy Duty Hoist & Weatherproof Service) (See Pg. 2, Para. 2)

Ref. No.	Part Number	Description	Qty. Req'd.
*	BH-1925	Push Button Station & Conductor Cable Assembly	1
	BH-1926	Conductor Cable Assembly (Not Shown)	1
	BH-1927	Push Button Station Assembly (Includes Items 2 thru 6 & 11)	1
1	BH-1928	Cord Grip	1
2	BH-1929	Body — Push Button Station	1
3	BH-1930	Anchor — Cord Grip	1
4	BH-1931	Interior Assembly Complete	1
5	BH-1932	Gasket — Cover	1
6	BH-1933	Cover — Push Button Station	1
7	BH-1934	Nut — Elastic Stop	1
8	BH-1935	Spacer — Strain Reliever	1
9	BH-1936	Washer — Flat	1
10	BH-1937	Bolt — Round Head	1
11	BH-1938	Screw — Cover	4

* These assemblies are for standard 10' lift hoists. When ordering replacements for hoists with other than standard lifts, specify lift.

NOTES

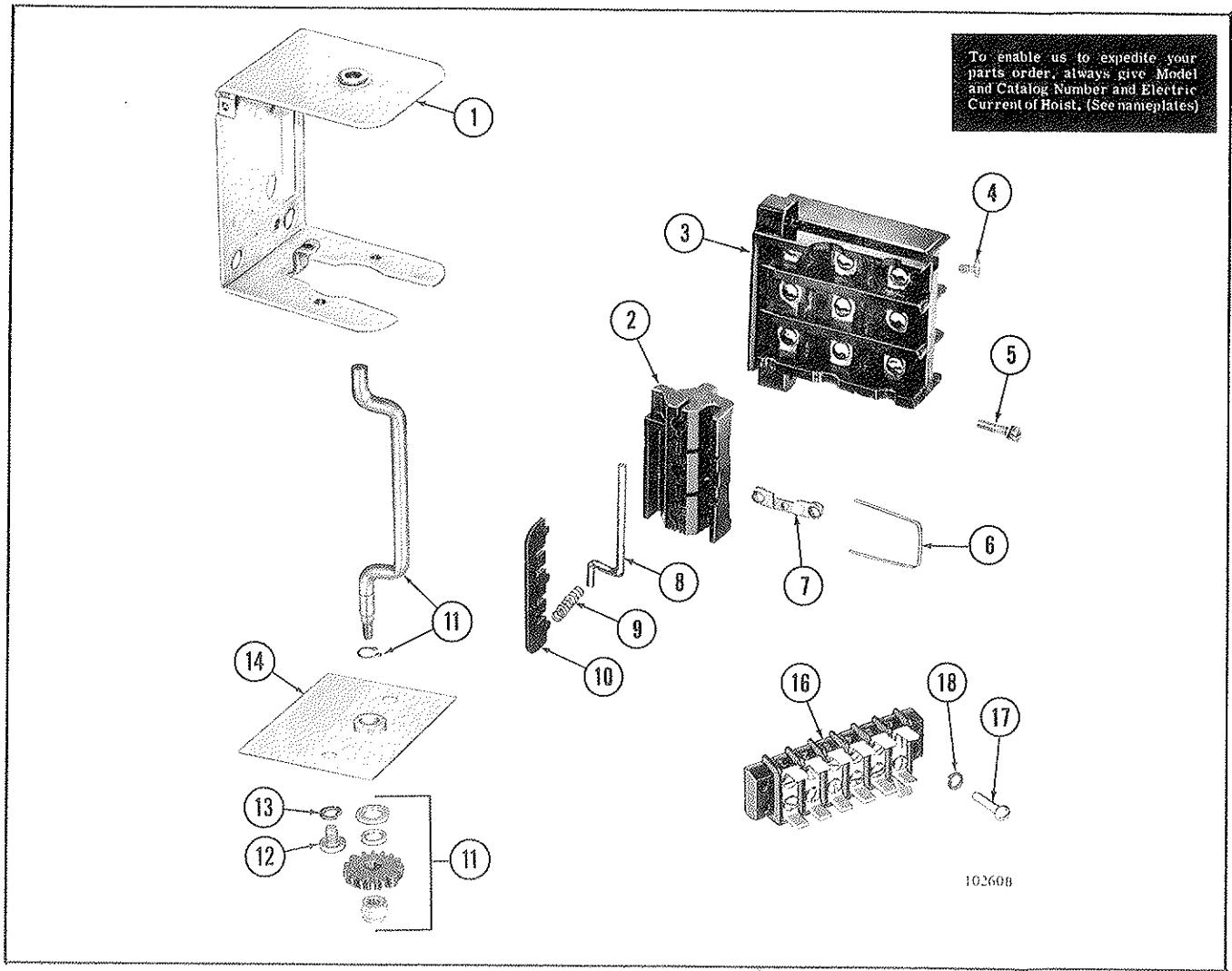

Figure 14. CONTROLLER ASSEMBLY – EXPLODED VIEW
(Pull Cord Model Hoists)

Ref. No.	Part Number	Description	Qty. Req'd.
	BH-2001	Controller Assembly – Complete	1
1	BH-2002	Frame Assembly – Mounting	1
2	BH-2003	Board – Movable Contact	1
3*	BH-2004	Board Assembly – Stationary Contact	1
4*	BH-2005	Screw – Terminal, plated	7
5	BH-2006	Screw & Lockwasher – Fillister Head	2
6*	BH-2007	Clip – Wire	1
7*	BH-2008	Contact Assembly – Movable	3
8	BH-2009	Shaft – Movable Contact Board	1
9*	BH-2010	Spring – Contact	3
10	BH-2011	Retainer – Spring	1
11**	BH-2012	Shaft Assembly – Controller (Includes item 14)	1
12	BH-2013	Screw – Binding Head Machine	2
13	BH-2014	Lockwasher – Spring Type	2
14	BH-2015	Plate Assembly – Lower Bearing	1
16	BH-2021	Block – Terminal (For 3 phase reconnectable models)	1
17	BH-2018	Screw – Round Head Machine	2
18	BH-2019	Lockwasher – Spring Type	2
	BH-2020	Ring – Retaining (Not illustrated – Use with Ref. No. 11)	1

* Above parts also available in Contact Kit form. Order Kit No. BH-2017.

** Furnished only as Assembly with Ref. 14.

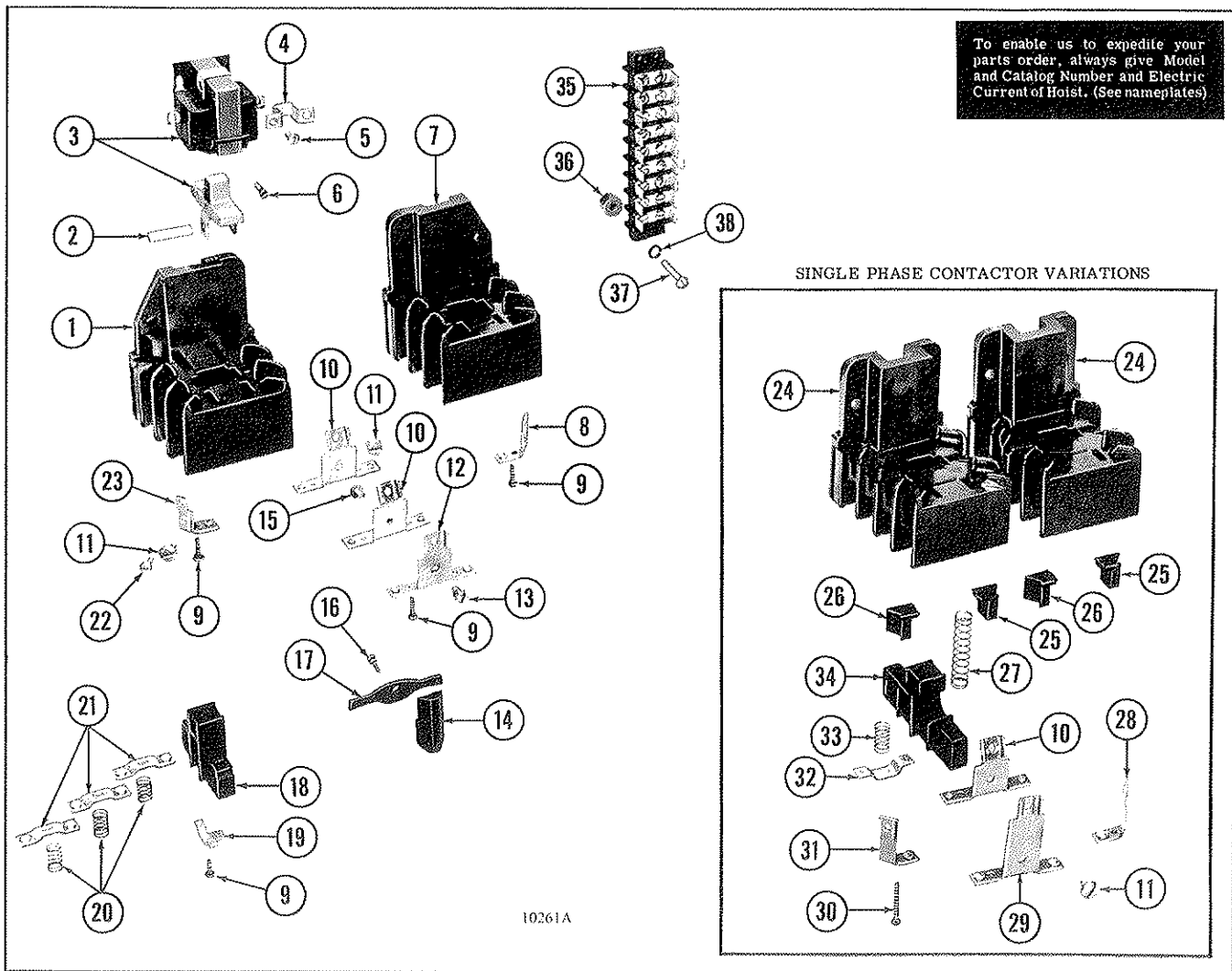
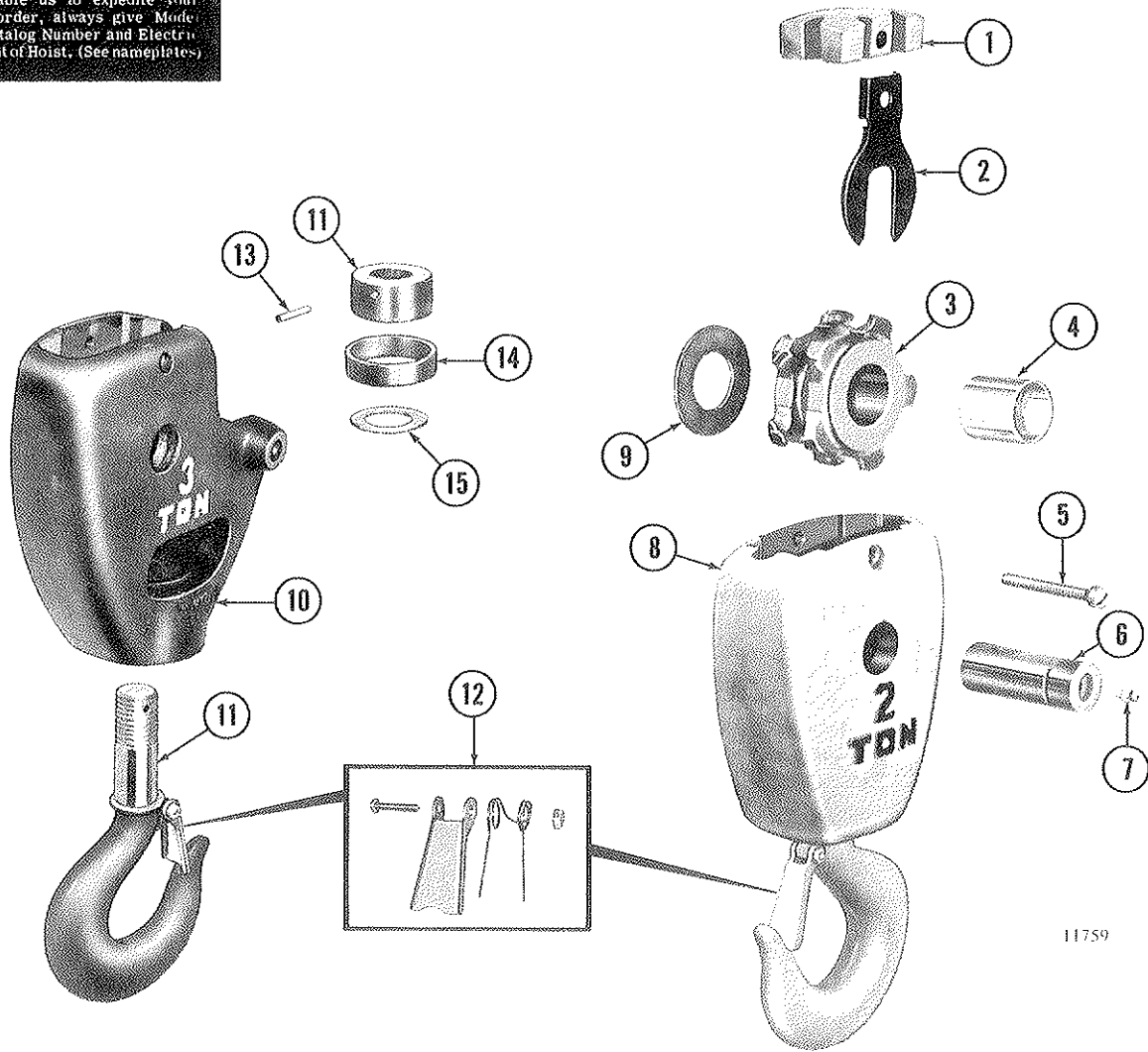

Figure 15. CONTACTOR ASSEMBLY -- EXPLODED VIEW
 (Push Button Model)
 (Standard & Extra Heavy Duty Hoists) (See Pg. 2, Para. 2)

Ref. No.	Part Number	Description	Quantity Required		
			115/1/60	230/1/60	All 3 Phase
	BH-2101	Contact Assembly -- Complete, 115 v. Coil	1	--	--
	BH-2102	Contact Assembly -- Complete, 24 v. Coil	1	1	1
	BH-2103	Contact Assembly -- Complete, 24V.	--	--	1
	BH-2145	Contact Assembly -- Complete, 115V.	--	--	1
1	BH-2104	Board -- Contact (L.H.)	--	--	1
2	BH-2105	Pin -- Pusher, nylon	2	2	2
3	BH-2106	Solenoid Assembly -- 24 volt	--	--	2
	BH-2146	Solenoid Assembly -- 115 volt	--	--	2
	BH-2107	Solenoid Assembly -- 24 volt	2	2	--
	BH-2108	Solenoid Assembly -- 115 volt	2	--	--
4	BH-2109	Jumper	1	1	1
5	BH-2110	Screw -- Terminal, solenoid	4	4	4
6	BH-2111	Screw & Lockwasher -- Fillister Head	4	4	4
7	BH-2112	Board -- Contact, (R.H.)	--	--	1
8*	BH-2113	Contact Assembly -- Stationary (R.H.)	3	3	3
9	BH-2114	Screw -- Pan Head Self-threading	12	12	16
10*	BH-2115	Terminal Assembly -- Rear & Center	3	3	2
11	BH-2116	Screw -- Terminal	4	4	4
12*	BH-2117	Terminal Assembly -- Front	--	--	1
13	BH-2118	Screw -- Fillister Head	--	--	1

To enable us to expedite your parts order, always give Model and Catalog Number and Electric Current of Hoist. (See nameplates)



11759

Figure 16. 2 & 3 TON LOWER BLOCK ASSEMBLIES — EXPLODED VIEW
 (Coil Chain Model Hoists, 2 & 3 Ton Standard Hoists & 2 Ton Extra Heavy Duty Hoists) (See Pg. 2, Para. 2)

Ref. No.	Part Number	Description	Quantity 2 Ton	Quantity Required 3 Ton
	BH-2201	Block Assembly — Lower Complete	1	—
1	BH-2218	Block Assembly — Lower Complete	—	1
	BH-2202	Guide — Center	1	1
2	BH-2203	Lock — Sprocket Pin	1	1
3	BH-2204	Sprocket — Coil Chain	1	1
4	BH-2205	Bushing — Sprocket	1	1
5	BH-2206	Screw — Fillister Head, Self locking	1	1
6	BH-2207	Pin — Sprocket	1	1
7	BH-2208	Fitting — Hydraulic Drive	1	1
8	BH-2209	Body & Hook Assembly — Lower Block	1	—
9	BH-2210	Washer, Thrust	1	1
10	BH-2211	Body Assembly — Lower Block	—	1
11	BH-2212	Hook/Latch & Nut (Includes Item 12)	—	1
12	BH-2213	Latch Kit, Hook	1	—
	BH-2214	Latch Kit, Hook	—	1
13	BH-2215	Pin, Grooved	—	1
14	BH-2216	Shroud	—	1
15	BH-2217	Washer, Thrust	—	1

To enable us to expedite your parts order, always give Model and Catalog Number and Electric Current of Hoist. (See nameplates)

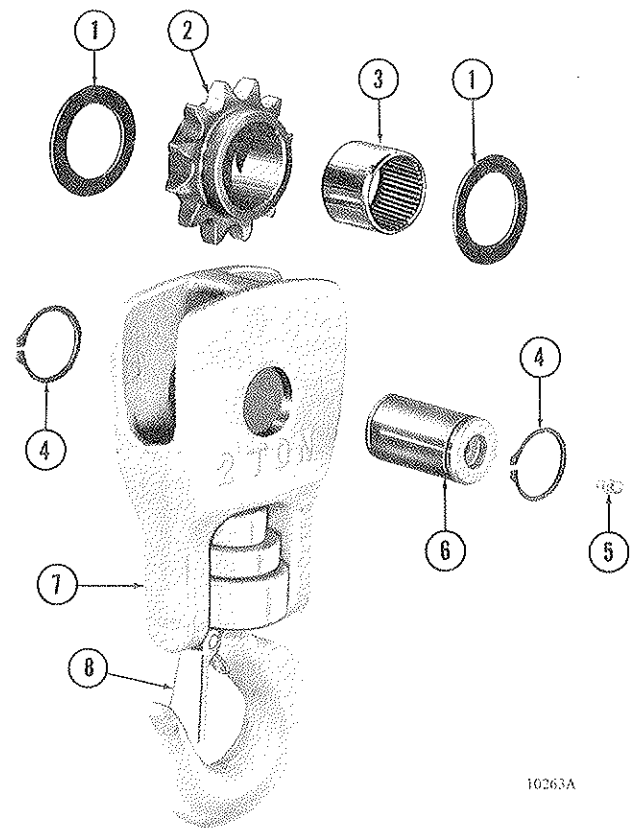

10263A

Figure 17. 2 TON LOWER BLOCK ASSEMBLY — EXPLODED VIEW
(Roller Chain Model Hoists)

Ref. No.	Part Number	Description	Qty. Req'd.
1	BH-2301	Block Assembly — lower, complete	1
2	BH-2302	Washer — Spring Thrust	2
3	BH-2303	Sprocket — Chain	1
4	BH-2304	Bearing Assembly — Needle	1
5	BH-2305	Ring — Retaining, external	2
6	BH-2208	Fitting — Hydraulic Drive	1
7	BH-2307	Pin — Sprocket	1
8	BH-2308	Body and Hook Assembly — Lower Block (Includes Item 8 below)	1
	BH-2213	Latch Kit — Hook	1

NOTICE

Always insist on genuine BUDGIT Hoist replacement parts when servicing this equipment. Parts are available from your local Authorized Repair Station or the factory at Muskegon.

To enable us to expedite your parts order, always give Model and Catalog Number and Electric Current of Hoist. (See nameplates)

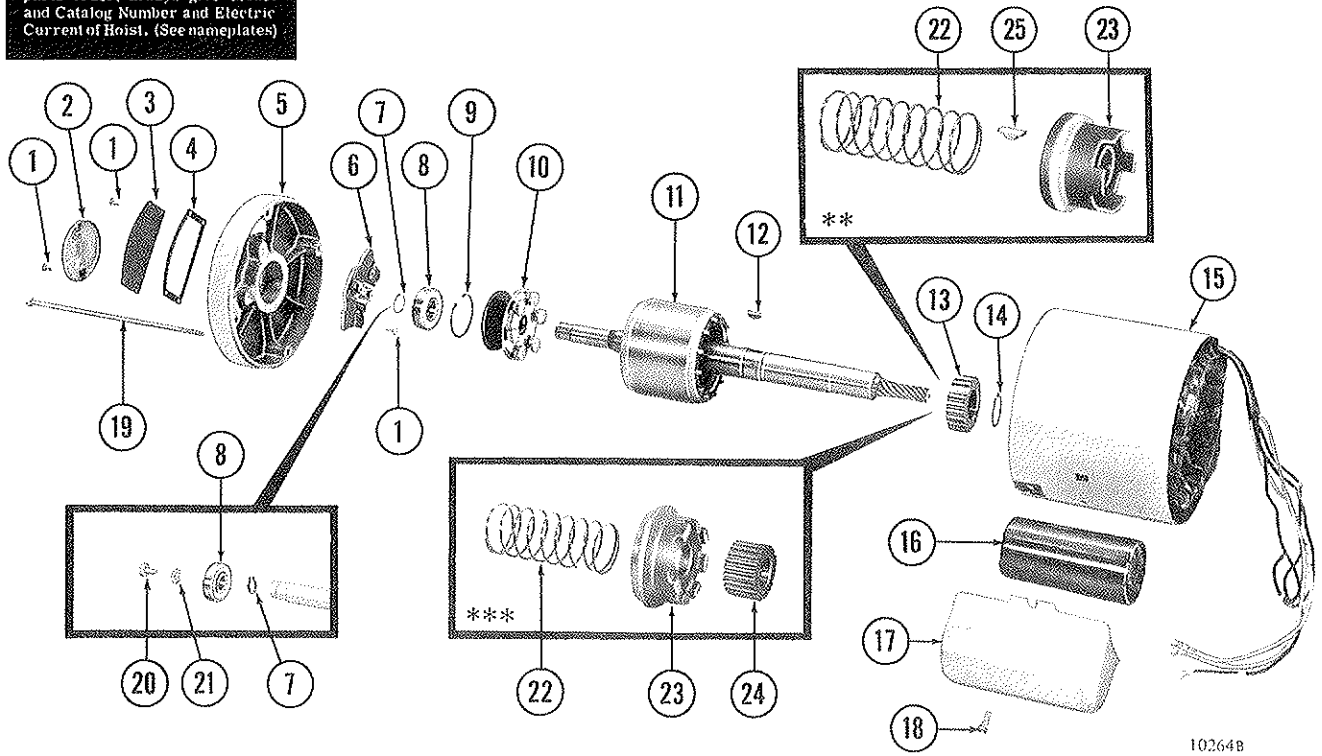

Figure 18. SINGLE PHASE MOTOR ASSEMBLIES – EXPLODED VIEW
(Push Button and Pull Cord Model Hoists)

Ref. No.	Part Number	Description	Quantity Required		
			1/4 H.P.	1/2 H.P.	1 H.P.
	(See Fig. 22)	Motor Assembly – Complete (For Pull Cord Models)	1	1	1
	(See Fig. 22)	Motor Assembly – Complete (For Push Button Models)	1	1	—
1	BH-2401	Screw – Round Head Self Tapping	10	10	10
2	BH-2402	Cover – Motor Shaft	1	1	1
3	BH-2403	Cover – End Bell	1	1	1
4	BH-2404	Gasket – End Bell Cover	1	1	1
5	BH-2405	Bell – End	1	1	1
6	BH-2406	Switch Assembly – Stationary	1	1	1
7	BH-2407	Ring – Retaining, external	2	2	2
8	BH-2408	Bearing Assembly – Ball	1	1	1
9	BH-2409	Ring – Retaining, Internal	1	1	1
10	BH-2410	Switch Assembly – Centrifugal	1	1	1
11	(See Fig. 22)	Rotor & Shaft Assembly	1	1	1
12	BH-2411	Key – Woodruff	1	1	1
13* **	BH-2412	Hub – Motor Brake, splined	1	1	1
14	BH-2413	Ring – Retaining	1	1	1
15	(See Fig. 22)	Stator Assembly (Includes Items 6, 16, 17 & 18)	1	1	1
16	BH-2414	Capacitor Assembly – 115 volt	1	—	—
	BH-2415	Capacitor Assembly – 230 volt	1	—	—
	BH-2416	Capacitor Assembly – 115 volt	—	1	—
	BH-2417	Capacitor Assembly – 230 volt	—	1	—
	BH-2418	Capacitor Assembly – 230 volt	—	—	1
17	BH-2419	Cover – Capacitor	1	1	—
	BH-2420	Cover – Capacitor	—	—	1
18	BH-2421	Screw – Truss Head Self Tapping	2	2	2
19*	BH-2422	Bolt – Motor Mounting	4	4	—
**	BH-2440	Bolt – Motor Mounting	4	4	—
***	BH-2423	Bolt – Motor Mounting	4	4	—

To enable us to expedite your parts order, always give Model and Catalog Number and Electric Current of Hoist. (See nameplates)

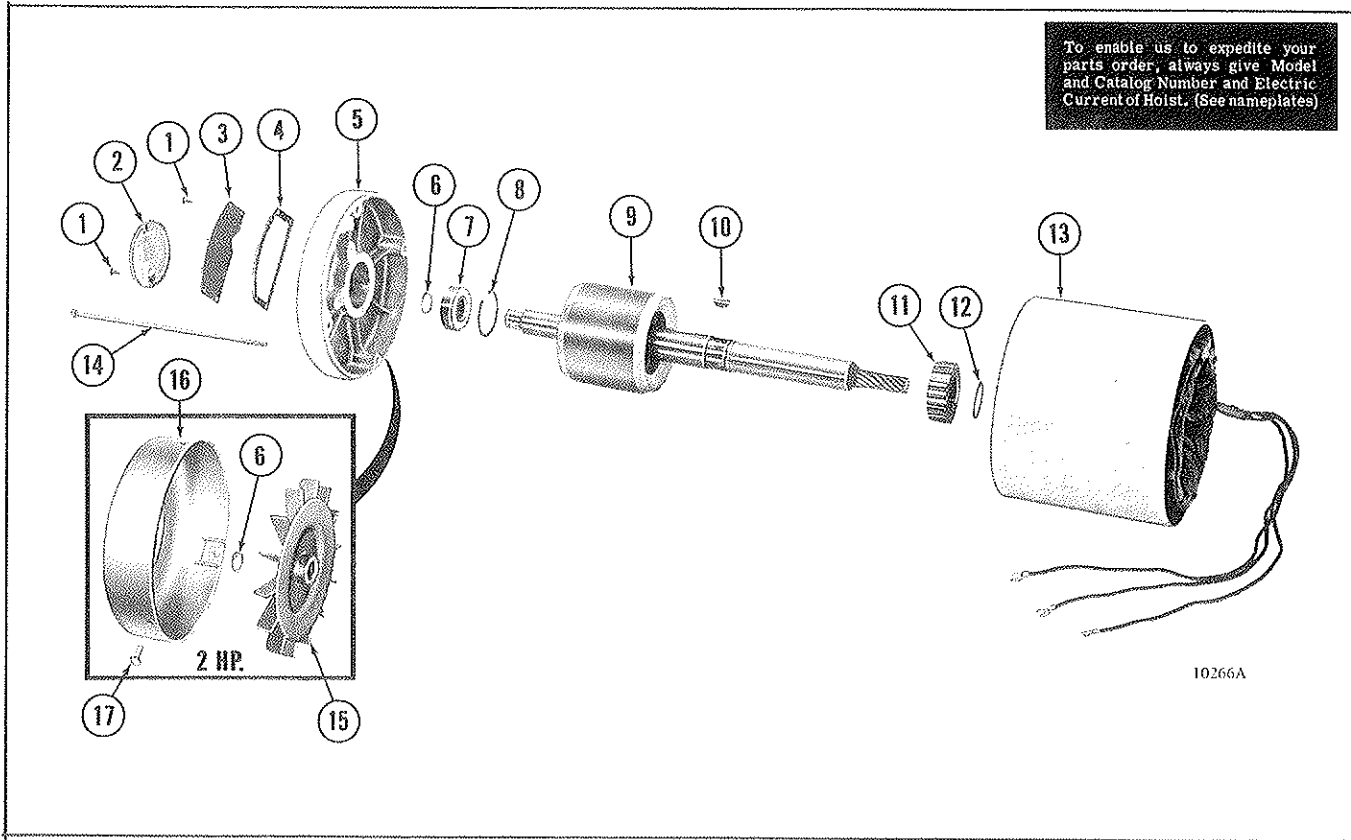

Figure 19. THREE PHASE MOTOR ASSEMBLY – EXPLODED VIEW
 (Standard Push Button and Pull Cord Model Hoists 1/4, 1/2, 1 & 2 H.P. Motors)
 (For Extra Heavy Duty Motors See Figure 20 & 21)

Ref. No.	Part Number	Description	Qty. Req'd.
	(See Fig. 22)	Motor Assembly – Complete (For Pull Cord Models)	1
	(See Fig. 22)	Motor Assembly – Complete (For Push Button Models)	1
1**	BH-2401	Screw – Round Head Self Tapping	2
2**	BH-2402	Cover – Motor Shaft	1
3**	BH-2403	Cover – End Bell	1
4**	BH-2404	Gasket – End Bell Cover	1
5	BH-2405	Bell – End (Without Tapped Holes for fan guard)	1
	BH-2506	(With Tapped Holes for fan guard)	1
6*	BH-2407	Ring – Retaining, external	1
7	BH-2408	Bearing Assembly – Ball	1
	BH-2507	Bearing Assembly – Ball (2 H.P.)	1
8	BH-2409	Ring – Retaining, internal	1
9	(See Fig. 22)	Rotor & Shaft Assembly	1
10	BH-2411	Key – Woodruff	1
11	BH-2412	Hub – Motor Brake, splined	1
12	BH-2413	Ring – Retaining, external	1
13	(See Fig. 22)	Stator Assembly	1
14		Bolt – Motor Mounting	
	BH-2501	(Pull Cord Model Hoists)	4
	BH-2502	(Push Button Model Hoists) 1/4, 1/2 & 1 H.P.	4
	BH-2442	(Push Button Model Hoists) (2 H.P.)	4
15	BH-2505	Fan (2 H.P.)	1
16	BH-2504	Guard & Spacer Assembly – Fan (2 H.P.)	1
17	BH-2533	Screw – Self tapping (2 H.P.)	3

* Quantity (2) for 2 H.P. Motors

** Not Required for 2 H.P. Motors

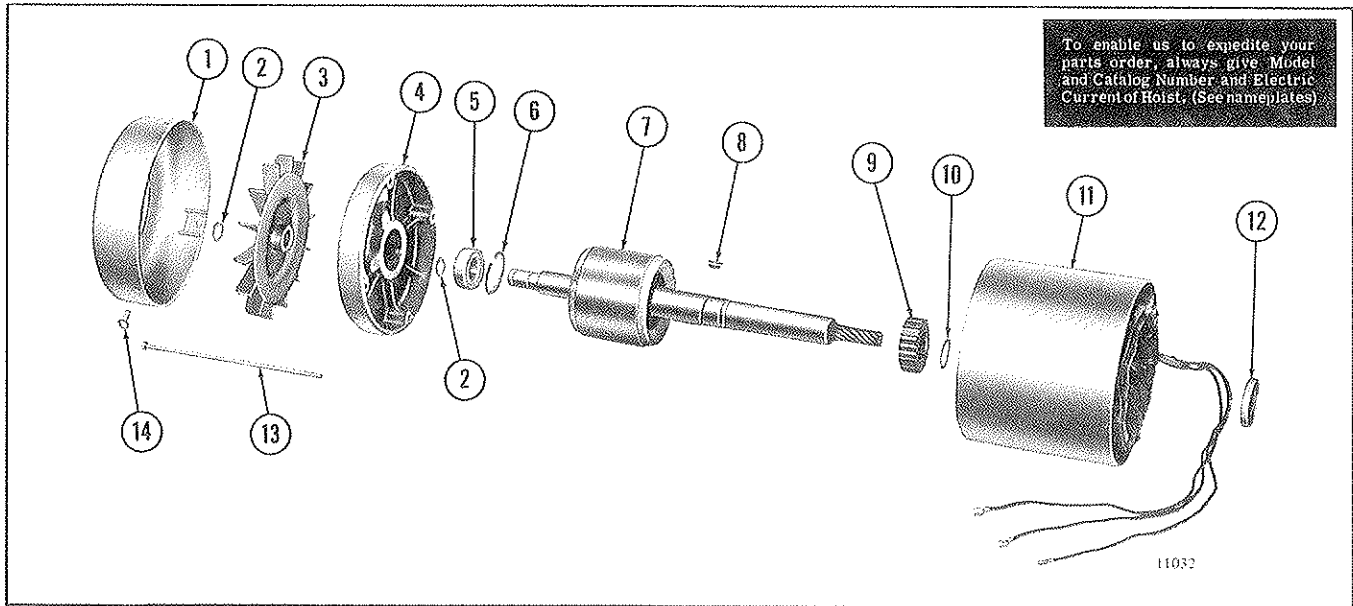

Figure 20. THREE PHASE MOTOR ASSEMBLY — EXPLODED VIEW
Extra Heavy Duty Model Hoists (See Pg. 2, Para 2)

Ref. No.	Part Number	Description	Qty. Req'd.
1	(See Fig. 21) BH-2504	Motor Assembly — Complete	1
2	BH-2407	Guard — Fan	1
3	BH-2407	Ring — Retaining, external	2
4	BH-2505	Fan	1
5	BH-2506	Bell — End	1
6	BH-2507	Bearing Assembly — Ball	1
7	BH-2409	Ring — Retaining, internal	1
8	(See Fig. 21)	Rotor & Shaft Assembly	1
9	BH-2411	Key — Woodruff	1
10	BH-2412	Hub — Motor Brake, splined	1
11	BH-2413	Ring — Retaining, external	1
12	(See Fig. 21)	Stator Assembly	1
13	BH-2532	Seal — Oil, motor shaft	1
14	BH-2502	Bolt — Motor Mounting	4
	BH-2533	Screw — Self tapping	3

Figure 21. REPLACEMENT MOTOR TABLE — EXTRA HEAVY DUTY MODEL HOISTS

Motor H.P.	Hoist Model Used On	A. C. Voltage	Part Number		
			Motor Assembly	Rotor & Shaft Assembly	Stator Assembly
1/4	Extra Heavy Duty Hoist Push Button	230-3-60	†	†	†
		460-3-60	†	†	†
		575-3-60	BH-2536	†	BH-2522
		208-3-60	BH-2537	†	BH-2523
		230/460-3-60	BH-2538	BH-2549	BH-2552
1/2	Extra Heavy Duty Hoist Push Button	230-3-60	†	†	†
		460-3-60	†	†	†
		575-3-60	BH-2541	†	BH-2526
		208-3-60	BH-2542	†	BH-2527
		230/460-3-60	BH-2543	BH-2550	BH-2553
1	Extra Heavy Duty Hoist Push Button	230-3-60	†	†	†
		460-3-60	†	†	†
		575-3-60	BH-2546	†	BH-2530
		208-3-60	BH-2547	†	BH-2531
		230/460-3-60	BH-2548	BH-2551	BH-2554

† Parts marked with this symbol are not available. For interchangeable replacement, order BH- number for dual voltage 230/460-3-60 part listed in same block.

Figure 22. REPLACEMENT MOTOR TABLE – STANDARD MODEL HOISTS
(Includes: Motor Assemblies, Rotor and Shaft Assemblies and Stator Assembly)

Motor H.P.	Hoist Model Used On	A. C. Voltage	Part Number			
			#Motor Assembly	Rotor & Shaft Assembly	*** Stator Assembly	
1/4	Pull Cord Models (Manual Brake)	115-1-60	BH-2601	BH-2610*	BH-2619	
		230-1-60	BH-2602	BH-2611*	BH-2620	
		208-3-60	BH-2701	†	BH-2761	
		230-3-60	†	†	†	
		460-3-60	†	†	†	
		575-3-60	BH-2704	†	BH-2764	
		230/460-3-60	BH-2705	BH-2735	BH-2765	
	Push Button Models (Magnetic Brake)	115-1-60	BH-2603††	BH-2612**	BH-2621††	
		230-1-60	BH-2604††	BH-2613**	BH-2622††	
		208-3-60	BH-2706	†	BH-2766	
		230-3-60	†	†	†	
		460-3-60	†	†	†	
		575-3-60	BH-2709	†	BH-2769	
		230/460-3-60	BH-2710	BH-2740	BH-2770	
1/2	Pull Cord Models (Manual Brake)	115-1-60	BH-2605	BH-2614*	BH-2623	
		230-1-60	BH-2606	BH-2615*	BH-2624	
		208-3-60	BH-2711	†	BH-2771	
		230-3-60	†	†	†	
		460-3-60	†	†	†	
		575-3-60	BH-2714	†	BH-2774	
		230/460-3-60	BH-2715	BH-2745	BH-2775	
	Push Button Models (Magnetic Brake)	115-1-60	BH-2607††	BH-2616**	BH-2625††	
		230-1-60	BH-2608††	BH-2617**	BH-2626††	
		208-3-60	BH-2716	†	BH-2776	
		230-3-60	†	†	†	
		460-3-60	†	†	†	
		575-3-60	BH-2719	†	BH-2779	
		230/460-3-60	BH-2720	BH-2750	BH-2780	
1	Pull Cord Models (Manual Brake)	230-1-60	BH-2609	BH-2618*	BH-2627	
		208-3-60	BH-2721	†	BH-2781	
		230-3-60	†	†	†	
		460-3-60	†	†	†	
		575-3-60	BH-2724	†	BH-2784	
		230/460-3-60	BH-2725	BH-2755	BH-2785	
		Push Button Models (Magnetic Brake)	230-1-60	BH-2630††	BH-2631**	BH-2632††
	208-3-60		BH-2726	†	BH-2786	
	230-3-60		†	†	†	
	460-3-60		†	†	†	
	575-3-60		BH-2729	†	BH-2789	
	230/460-3-60		BH-2730	BH-2760	BH-2790	
	2		Push Button Models (Magnetic Brake)	208-3-60	BH-2791	BH-2794
		575-3-60		BH-2793	BH-2796	BH-2799
230/460-3-60		BH-2792		BH-2795	BH-2798	

Motor Assemblies for Push Button Models include brake discs & plates.

* Above rotor and shaft assemblies include the centrifugal switch, brake hub, and retaining ring.

** Above rotor and shaft assemblies include the centrifugal switch, brake spring, brake plunger, brake hub, and retaining ring.

*** Stator Assemblies for single phase motors include stationary switch, capacitor, capacitor cover and cover mounting screws.

† Parts marked with this symbol are not available. For interchangeable replacement, order BH-number for dual voltage 230/460-3-60 part listed in same block.

†† Single phase motor assemblies (BH-2603, BH-2604, BH-2607, BH-2608, BH-2630) and stator assemblies (BH-2621, BH-2622, BH-2625, BH-2626, BH-2632) for Push Button Model Hoists prior to Model Number 325919-1 are no longer available. Current production motor assembly, complete with brake, discs & plates, will be substituted when either stator or motor is ordered.

AUTHORIZED REPAIR STATIONS

Owners of BUDGIT® and TUGIT® hoisting products may obtain parts and service quickly from our Authorized Repair Stations located in the cities listed below. These Authorized Repair Stations carry comprehensive inventories of BUDGIT and TUGIT Parts, and offer complete repair service by skilled mechanics. Factory Minimum Charge for replacement parts is TWENTY DOLLARS.

ALABAMA
Birmingham

GEORGIA
Atlanta

MINNESOTA
Minneapolis

OREGON
Portland

ARIZONA
Glendale
Tucson

ILLINOIS
Chicago
Peoria

MISSISSIPPI
Jackson

PENNSYLVANIA
Pittsburgh
Philadelphia
Lancaster
Kingston
Monroeville

ARKANSAS
North Little Rock

INDIANA
Indianapolis
South Bend
Fort Wayne

MISSOURI
Kansas City
St. Louis

RHODE ISLAND
Providence

CALIFORNIA
Los Angeles
Fresno
Oakland

IOWA
Davenport
Des Moines

NEBRASKA
Omaha

TENNESSEE
Chattanooga
Memphis
Knoxville
Nashville

CANADA
Montreal, P.Q.
Toronto, Ont.
Vancouver, B.C.
Quebec City
Calgary, Alberta
Windsor, Ontario
Galt, Ontario
Port Arthur, Ont.
London, Ontario

KENTUCKY
Louisville

NEW MEXICO
Albuquerque

TEXAS
Dallas
Houston
Odessa
Lubbock

COLORADO
Denver

LOUISIANA
New Orleans
Monroe
Shreveport
Baton Rouge

NEW YORK
Buffalo
Long Island City
Syracuse

UTAH
Salt Lake City

CONNECTICUT
Bridgeport

MARYLAND
Baltimore

NORTH CAROLINA
Charlotte

VIRGINIA
Roanoke

FLORIDA
Miami
Orlando

MASSACHUSETTS
South Boston
Springfield

OHIO
Cleveland
Cincinnati
Toledo
Columbus

WASHINGTON
Seattle

MICHIGAN
Detroit
Muskegon
Scotts
Lansing

OKLAHOMA
Tulsa
Oklahoma City

WISCONSIN
Milwaukee